

**BOH SOLUTIONS OPERATION MANUAL
(INCLUDING REPAIR PARTS)
EXPEDITIONARY JOINT OPERATIONS CENTER (EJOC®)**

CHAPTER 6

PARTS SUPPORTING INFORMATION

This page was intentionally left blank

PARTS SUPPORTING INFORMATION

BOH SOLUTIONS OPERATION MANUAL
(INCLUDING REPAIR PARTS)
EXPEDITIONARY JOINT OPERATIONS CENTER (EJOC®)

INTRODUCTION TO MAINTENANCE ALLOCATION CHART (MAC)

INTRODUCTION

The BOH Solutions recommended MAC

This introduction provides a general explanation of all maintenance and repair functions authorized at various maintenance levels under the standard Army Maintenance System concept.

The MAC (WP 0025 00), immediately following the introduction) designates overall authority and responsibility for the performance of maintenance functions on the EJOC System. The application of the maintenance functions to the EJOC System shall be consistent with the capacities and capabilities of the designated maintenance levels, which are shown on the MAC in column (4) as:

Unit – includes two sub columns, C (operator/crew) and O (unit) maintenance.

Direct Support – includes an F sub column.

General Support – includes an H sub column.

Depot – includes a D sub column.

Maintenance Functions

Maintenance functions are limited to and defined as follows:

1. **Inspect:** To determine the serviceability of an item by comparing its physical and mechanical characteristics with established standards through examination (e.g., by sight, sound, or feel). This includes scheduled inspections.
2. **Test:** To verify serviceability by measuring the mechanical characteristics of an item and comparing those characteristics with prescribed standards on a scheduled basis, i.e., load testing of lift devices and hydrostatic testing of pressure hoses.
3. **Service:** Operations required periodically to keep an item in proper operating condition; e.g., to clean (includes decontaminate, when required), to preserve, to drain, to paint, or to replenish fuel, lubricants, chemical fluids, or gases.
4. **Adjust:** To maintain or regulate, within prescribed limits, by bringing into proper position, or by setting the operating characteristics to specific parameters.
5. **Align:** To adjust specified variable elements of an item to bring about optimum or desired performance.
6. **Calibrate:** To determine and cause corrections to be made or to be adjusted on instruments of test, measuring, and diagnostic equipment used in precision measurement. Consists of comparisons of

two instruments, one of which is a certified standard of known accuracy, to detect and adjust any discrepancy in the accuracy of the instrument being compared.

7. **Remove/Install:** To remove and install the same item when required to perform service or other maintenance functions. Install may be the act of emplacing, seating, or fixing into position a spare, repair part, or module (component or assembly) in a manner to allow the proper functioning of an equipment or system.
8. **Replace:** To remove an unserviceable item and install a serviceable counterpart in its place. "Replace" is authorized by the MAC and assigned maintenance level is shown as the third position code of the Source, Maintenance and Recoverability (SMR) code.
9. **Repair:** The application of maintenance services, including fault location-Troubleshooting, removal/installation, disassembly/assembly procedures, and maintenance actions to identify troubles and restore serviceability to an item by correcting specific damage, fault, malfunction, or failure in a part, subassembly, module (component or assembly), end item, or system.

NOTE

The following definitions are applicable to the "REPAIR" maintenance functions of Service, Inspect, Test, Adjust, Align, Calibrate, and/or Replace:

Fault location-Troubleshooting – The process of investigating and detecting the cause of equipment malfunctioning; the act of isolating a fault within a system or Unit Under Test (UUT).

Disassembly/Assembly – The step-by-step breakdown (taking apart) of a spare/functional group coded item to the level of its least component, that is assigned an SMR code for the level of maintenance under consideration (i.e., identified as maintenance significant).

Actions – Welding, grinding, riveting, straightening, facing, machining, and/or resurfacing.

10. **Overhaul:** That maintenance effort (service/action) prescribed to restore an item to a completely serviceable/operational condition as required by maintenance standards in appropriate technical publications. Overhaul is normally the highest degree of maintenance performed by the Army. Overhaul does not normally return an item to like new condition.
11. **Rebuild:** Consists of those services/actions necessary for the restoration of unserviceable equipment to a like new condition in accordance with original manufacturing standards. Rebuild is the highest degree of materiel maintenance applied to Army equipment. The rebuild operation includes the act of returning to zero those age measurements (e.g., hours/miles) considered in classifying Army equipment/components.

Explanation of Columns in the MAC

Column (1) – Group Number. Column (1) lists Functional Group Code (FGC) numbers, the purpose of which is to identify maintenance significant components, assemblies, subassemblies, and modules with the Next Higher Assembly (NHA).

Column (2) – Component/Assembly. Column (2) contains the item names of components, assemblies, subassemblies, and modules for which maintenance is authorized.

Column (3) – Maintenance Function. Column (3) lists the functions to be performed on the item listed in column (2). (For a detailed explanation of these functions refer to “Maintenance Functions” outlined above).

Column (4) – Maintenance Level. Column (4) specifies each level of maintenance authorized to perform each function listed in column (3), by indicating work time required (expressed as man-hours in whole hours or decimals) in the appropriate sub column. This work time figure represents the active time required to perform that maintenance function at the indicated level of maintenance. If the number or complexity of the tasks within the listed maintenance function varies at different maintenance levels, appropriate work time figures are to be shown for each level. The work time figure represents the average time required to restore an item (assembly, subassembly, component, module, end item, or system) to a serviceable condition under typical field operating conditions. This time includes preparation time (including any necessary disassembly/assembly time), troubleshooting/fault location time, and quality assurance time in addition to the time required to perform the specific tasks identified for the maintenance functions authorized in the MAC. The symbol designations for the various maintenance levels are as follows:

- **C – Operator or crew maintenance**
- **O– Unit maintenance**
- **F – Direct Support maintenance**
- **L – Specialized repair activity (SRA)**
- **H – General support maintenance**
- **K – Commercial depot maintenance**

NOTE

The "L", maintenance level is not included in column (4) of the MAC. Functions to this level of maintenance are identified by a work time figure in the "H" column of column (4), and an associated reference code is used in the REMARKS column (6). This code is keyed to the remarks and the SRA complete repair application is explained there.

Column (5) – Tools and Equipment Reference Code. Column (5) specifies, by code, those common tool sets (not individual tools), common Test, Measurement and Diagnostic Equipment (TMDE), and special tools, special TMDE and special support equipment required to perform the designated function.

Column (6) – Remarks Code. When applicable, this column contains a letter code, in alphabetical order, which is keyed to the remarks table entries.

Explanation of Columns in the Tools and Test Equipment Requirements

Column (1) – Tool or Test Equipment Reference Code. The tool or test equipment reference code correlates with a code used in column (5) of the MAC.

Column (2) – Maintenance Level. The lowest level of maintenance authorized to use the tool or test equipment.

Column (3) – Nomenclature. Name or identification of the tool or test equipment.

Column (4) – National Stock Number (NSN). The NSN of the tool or test equipment.

Column (5) – Tool Number. The manufacturer’s part number, model number, or type number.

Column (6) – Remarks Code. The code recorded in column (6) of the MAC.

Column (2) – Remarks. This column lists information pertinent to the maintenance function being performed as indicated in the MAC.

EXPLANATION OF COLUMNS IN THE REPAIR PARTS LIST

ITEM NO. (Column (1)). Indicates the number used to identify items called out in the illustration.

NSN (Column (2)). The NSN for the item is listed in this column.

CAGEC (Column (3)). The Commercial and Government Entity Code (CAGEC) is a five-digit code which is used to identify the manufacturer, distributor, or Government agency/activity that supplies the item.

PART NUMBER (Column (4)). Indicates the primary number used by the manufacturer (individual, company, firm, corporation, or Government activity), which controls the design and characteristics of the item by means of its engineering drawings, specifications, standards, and inspection requirements to identify an item or range of items.

NOTE

When you use an NSN to requisition an item, the item you receive may have a different P/N from the number listed.

DESCRIPTION AND USABLE ON CODE (UOC)

UOC (Column (5)). This column includes the following information:

The ITEM/Assembly Progression (.Item or Assembly, ..Next Lower Item, ...Next Lower Item)

1. The federal item name, and when required, a minimum description to identify the item.
2. P/Ns of bulk materials are referenced in this column in the line entry to be manufactured or fabricated.
3. Hardness Critical Item (HCI). A support item that provides the equipment with special protection from electromagnetic pulse (EMP) damage during a nuclear attack.
4. The statement END OF FIGURE appears just below the last item description in column (6) for a given figure in both the repair parts list and special tools list work packages.

QTY (Column (6)). The QTY (quantity per figure) column indicates the quantity of the item used in the breakout shown on the illustration/figure, which is prepared for a functional group, sub-functional group, or an assembly. An “AR” (as required) appearing in this column instead of a quantity indicates that the quantity is variable and quantity may change from application to application

ABBREVIATIONS

Abbreviation	Explanation
AY	ASSEMBLY
KT	KIT
FPU	FIELD PACK-UP UNIT
AR	AS REQUIRED

END OF WORK PACKAGE

PARTS SUPPORTING INFORMATION

BOH SOLUTIONS OPERATION MANUAL
(INCLUDING REPAIR PARTS)
EXPEDITIONARY JOINT OPERATIONS CENTER (EJOC®)

MAINTENANCE ALLOCATION CHART (MAC)

(1)	(2)	(3)	(4)					(5)	(6)
Group Number	Component/Assembly	Maintenance Function	Maintenance Level					Tools and Equipment Ref Code	Remarks
			Unit		Direct Support	General Support	Depot		
			C	O	F	H	D		
00	EJOC SYSTEM								
01	Expeditionary Joint Operations Center (EJOC)								
0101	Folding Steps	INSPECT	0.1	0.1					
		SERVICE		0.1					
		REPLACE			0.2				
0102	EJOC DOOR ASSEMBLY	INSPECT	0.5	0.5					
		SERVICE		0.2					
		REPLACE			2.0				
0103	DOOR HINGE ASSEMBLY	INSPECT	0.1	0.1					
		SERVICE		0.1					
		REPLACE			0.5				
0104	DOOR RETAINING STRAP AND D-RING	INSPECT	0.1	0.1					
		REPLACE			0.5				
0105	EJOC ELECTRIC BOX ASSEMBLY	INSPECT	0.1	0.1					
		SERVICE		0.1					
		REPLACE			1.5				
0106	ROOF TIE-DOWN RING	INSPECT	0.1						
		REPLACE			0.5				

(1) Group Number	(2) Component/Assembly	(3) Maintenance Function	(4) Maintenance Level					(5) Tools and Equipment Ref Code	(6) Remarks
			Unit		Direct Support	General Support	Depot		
			C	O	F	H	D		
0107	COMMS INLET ASSEMBLY	INSPECT	0.1	0.1					
		REPLACE			0.5				
0108	HVAC ACCESS DOOR ASSEMBLY	INSPECT	0.1	0.1					
		SERVICE		0.2					
		REPLACE			1.0				
0109	TOP CABINET ASSEMBLY	INSPECT	0.1	0.1					
		REPLACE		0.5					
0110	FILE CABINET ASSEMBLY	INSPECT	0.2	0.2					
		SERVICE		0.5					
		REPLACE		0.5					
0111	3 SHELF CABINET ASSEMBLY	INSPECT	0.2	0.2					
		SERVICE		0.5					
		REPLACE		0.5					
0112	PRINTER TRAY ASSEMBLY	INSPECT	0.2	0.2					
		REPLACE		0.5					
0113	COMMS INLET SLEEVE ASSEMBLY	INSPECT	0.1	0.1					
		REPLACE		0.1					
0114	DESK ASSEMBLY	INSPECT	0.1	0.1					
		SERVICE		0.1					
		REPLACE		1.5					
0115	WALL COMPONENTS	INSPECT	0.5	0.5					
		SERVICE		0.2					
		REPLACE		1.5					
0116	DESK PARTS	INSPECT	0.1	0.1					
		REPLACE		0.5					

(1)	(2)	(3)	(4)					(5)	(6)
Group Number	Component/Assembly	Maintenance Function	Maintenance Level					Tools and Equipment Ref Code	Remarks
			Unit		Direct Support	General Support	Depot		
			C	O	F	H	D		
0117	TACITCAL GEAR HOOKS	INSPECT	0.1	0.1					
		REPLACE		0.5					
0118	WEAPONS RACK	INSPECT	0.1	0.1					
		REPLACE		0.5					
0119	REAR ROLLER ASSEMBLY	INSPECT		0.1					
		SERVICE		0.1					
		REPLACE				0.2			
		REPAIR				0.3			
0120	WALL D-RINGS AND STRAPS	INSPECT	0.1	0.1					
		INSPECT		0.1					
		REPLACE		0.5					
0121	LIGHTING INTERRUPTER DOOR SWITCH	INSPECT	0.2	0.2					
		SERVICE		0.2					
		REPLACE			1				
0122	EJOC HVAC AND COMPLETE HOUSING ASSEMBLY	INSPECT	0.5	0.5					
		SERVICE		0.2					
		REPLACE			1.5				
0123	EJOC HVAC SLIDES AND COMPLETE SHROUD ASSEMBLY	INSPECT	0.5	0.5					
		SERVICE		0.2					
		REPLACE			1.5				
END OF MAC									

PARTS SUPPORTING INFORMATION

**BOH SOLUTIONS OPERATION MANUAL
(INCLUDING REPAIR PARTS)
EXPEDITIONARY JOINT OPERATIONS CENTER (EJOC®)**

EXTERIOR REPAIR PARTS

EXPEDITIONARY JOINT OPERATIONS CENTER (EJOC)

EJOC STREETSIDE - FIGURES 01 to 07

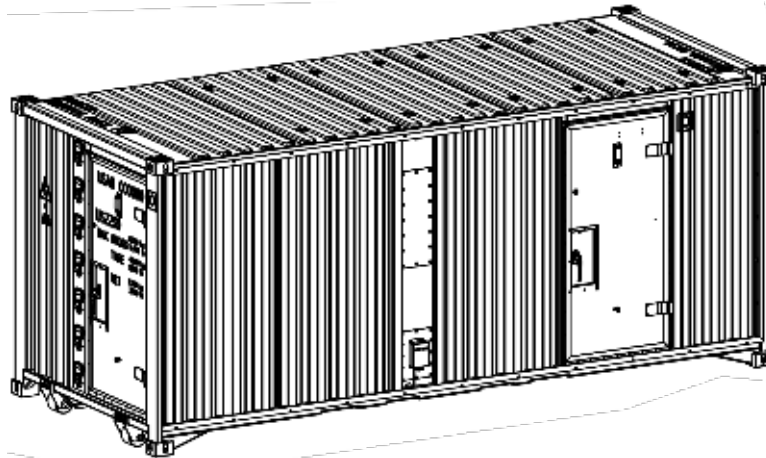

EJOC CURBSIDE - FIGURES 08 to 09

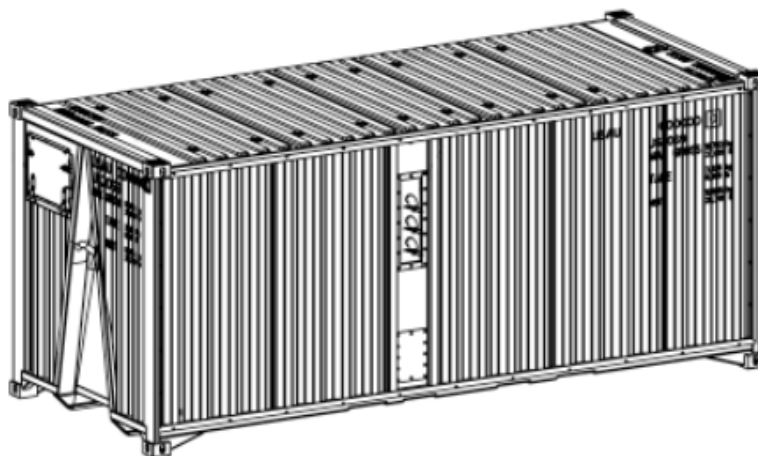

EXPEDITIONARY JOINT OPERATIONS CENTER (EJOC)

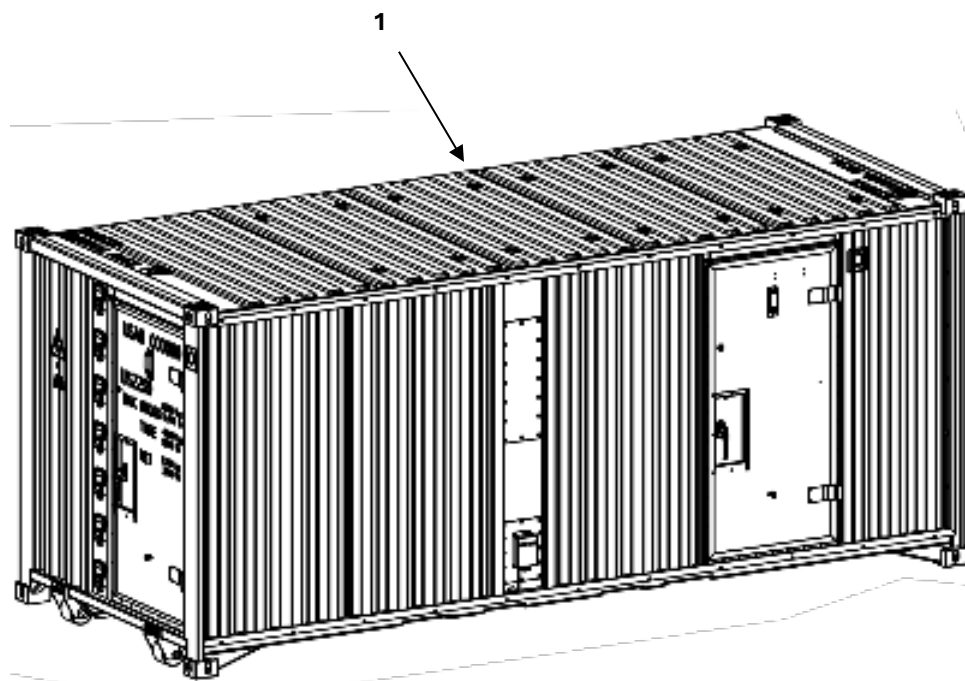

FIGURE 01 - EXPEDITIONARY JOINT OPERATIONS CENTER (EJOC)

(1) ITEM NO.	(2) NSN	(3) CAGEC	(4) PART NUMBER	(5) DESCRIPTION AND USABLE ON CODE (UOC)	(6) QTY
				GROUP 01 FIGURE 01 EXPEDITIONARY JOINT OPERATIONS CENTER (EJOC)	
1	N/A	1NSG3	15002007-001	EJOC EXPEDITIONARY JOINT OPERATIONS CENTER GREEN	1
1	N/A	1NSG3	15002007-002	EJOC EXPEDITIONARY JOINT OPERATIONS CENTER TAN	1
END OF FIGURE 01					

FOLDING STEPS

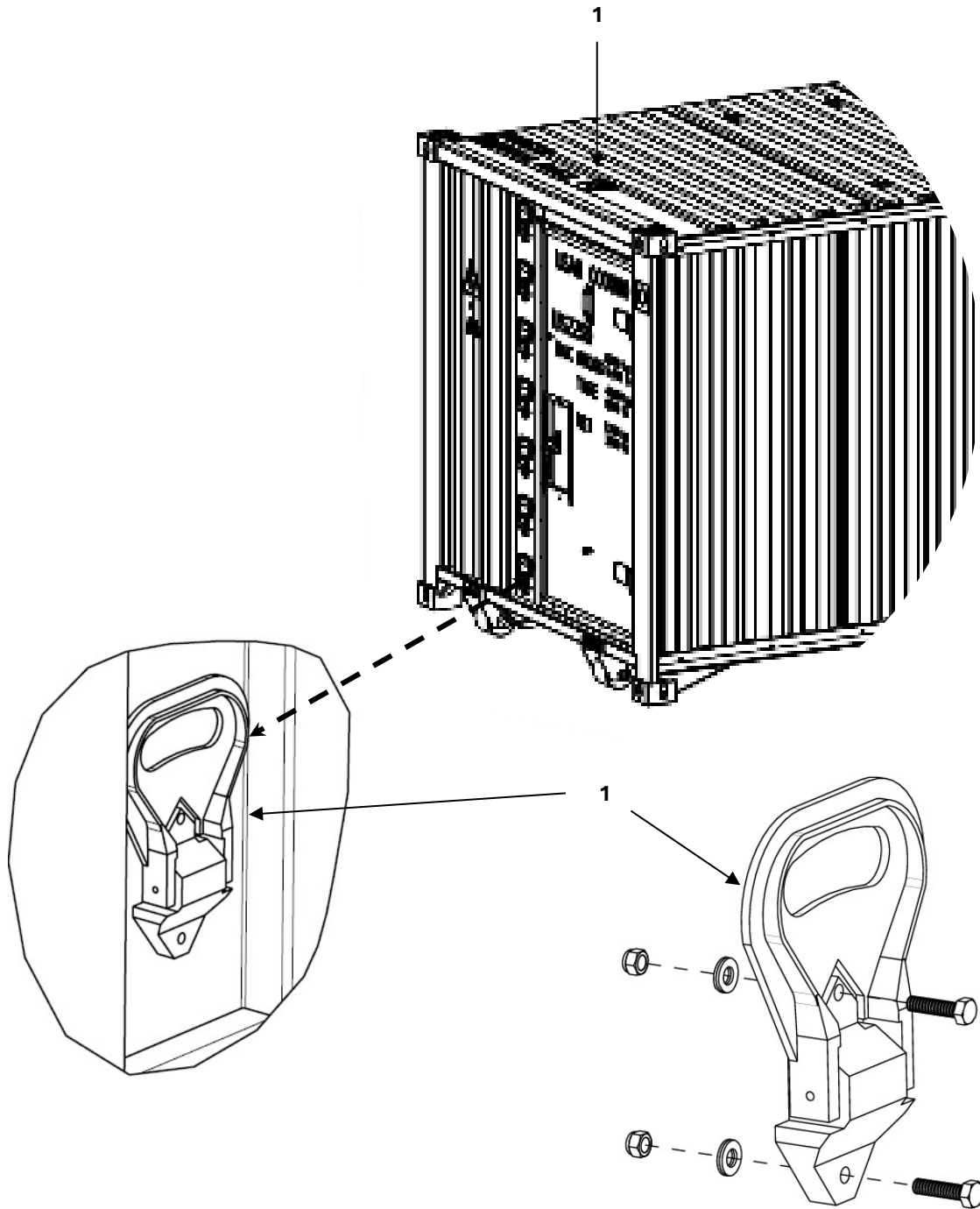

FIGURE 02 – FOLDING STEPS

(1) ITEM NO.	(2) NSN	(3) CAGEC	(4) PART NUMBER	(5) DESCRIPTION AND USABLE ON CODE (UOC)	(6) QTY
				GROUP 0101 FIGURE 02 FOLDING STEPS	
1	N/A	1NSG3	15100201-001	FOOT STEP W/ MOUNTING HARDWARE GREEN	1
1	N/A	1NSG3	15100201-002	FOOT STEP W/ MOUNTING HARDWARE TAN	1
END OF FIGURE 02					

EJOC DOOR ASSEMBLY

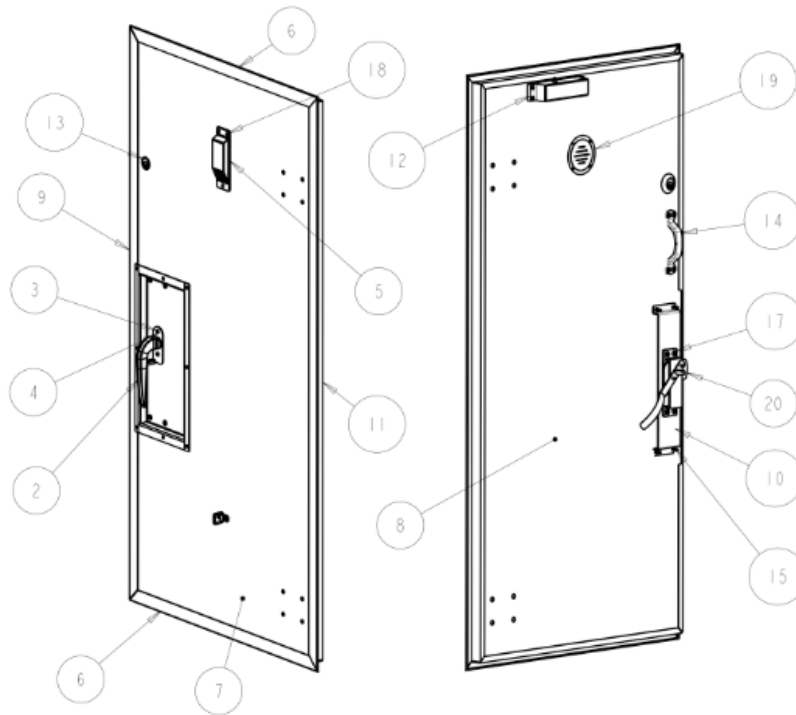
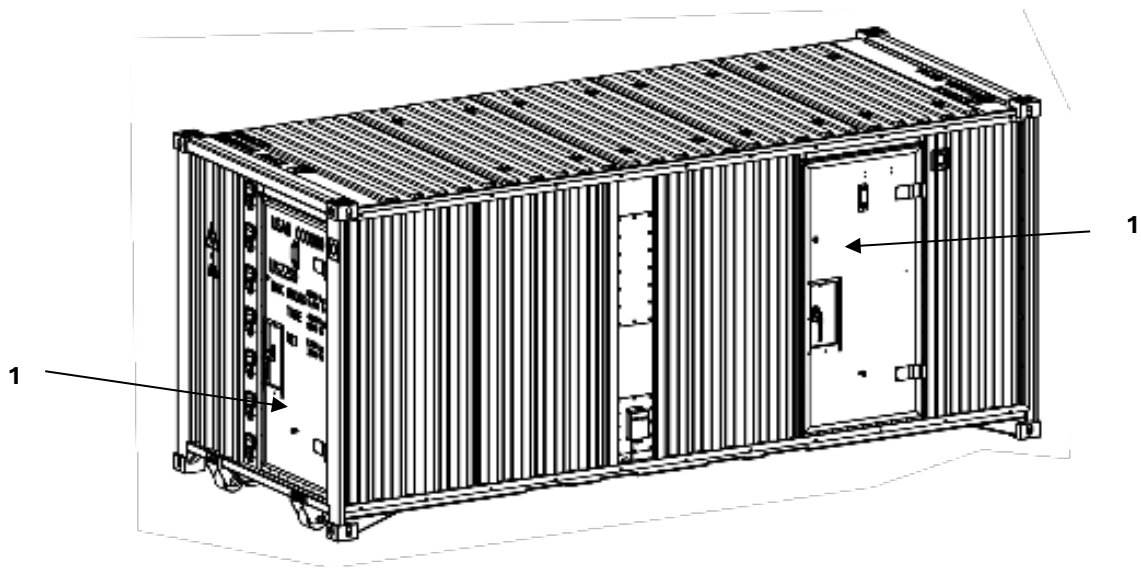

FIGURE 03 – EJOC DOOR ASSEMBLY

(1) ITEM NO.	(2) NSN	(3) CAGEC	(4) PART NUMBER	(5) DESCRIPTION AND USABLE ON CODE (UOC)	(6) QTY
				GROUP 0102 FIGURE 03 COMPLETE DOOR ASSEMBLY	
1	N/A	1NSG3	16370910-002	COMPLETE DOOR ASSY W/HDWR TAN	1
2	N/A	1NSG3	15100324	EXTERIOR DOOR HANDLE	1
3	N/A	1NSG3	15120841	SCREW MACH 1/4-20 X 1" ONE WAY HEAD	2
4	N/A	1NSG3	15121020	1/4-20 "T" NUT	2
5	N/A	1NSG3	15150120	VENT, CONTAINER, 4402- 2397-4	1
6	N/A	1NSG3	16370842	TOP DOOR TRIM ALUM	2
7	N/A	1NSG3	16370852	EJOC DOOR MAIN WLDMT	1
8	N/A	1NSG3	16370855	DOOR INT SKIN UPPER VENT	1
9	N/A	1NSG3	16370860	SIDE DOOR TRIM ALUM	1
10	N/A	1NSG3	16370871	EJOC DOOR DEADBOLT PLT	1
11	N/A	1NSG3	16370912	SIDE DOOR TRIM ALUM	1
12	N/A	1NSG3	74050320	DOOR CLOSER, TELL #DC100005-500-SER	1
13	N/A	1NSG3	74061244	DEAD BOLT	1
14	N/A	1NSG3	74090304	PULL HANDLE	1
15	N/A	1NSG3	78100304	NUT-NYLON LOCKNUT, SS, 1/4"-20	8
16	N/A	1NSG3	78370104	WASHER, FLAT, 1/4", SS	12
17	N/A	1NSG3	78500420	SCREW M/S P PH SS 1/4-20 X 1-1/4	12
18	N/A	1NSG3	78640304	POP RIVET, 3/16 X 1/4 - AB64 CLD	7
19	N/A	1NSG3	94400102	VENT, LOUVERED, ROUND, 5IN	1
20	N/A	1NSG3	15100321	DOOR DEAD BOLT LATCH #LC311 LH	1
END OF FIGURE 03					

EJOC DOOR HINGE

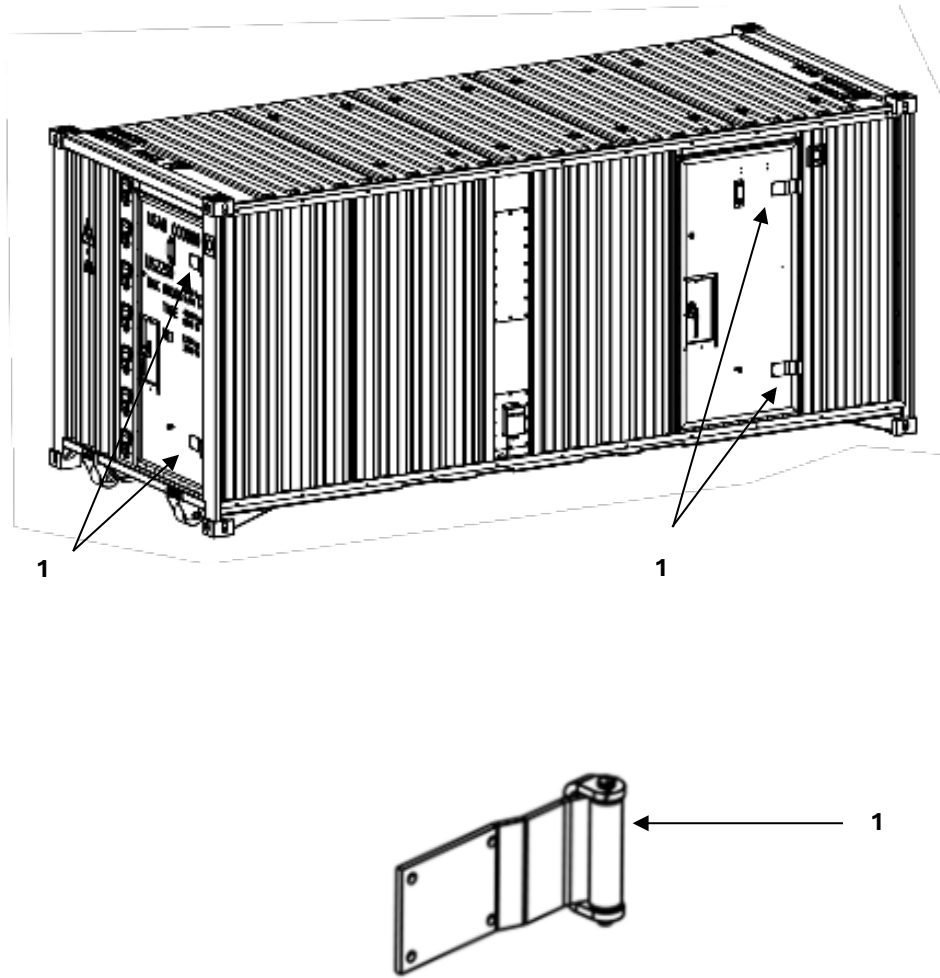

FIGURE 04 – EJOC DOOR HINGE

(1) ITEM NO.	(2) NSN	(3) CAGEC	(4) PART NUMBER	(5) DESCRIPTION AND USABLE ON CODE (UOC)	(6) QTY
				GROUP 0103 FIGURE 04 DOOR HINGE ASSEMBLY	
1	N/A	1NSG3	CONTACT BOH	COMPLETE DOOR HINGE ASSY GREEN	1
2	N/A	1NSG3	16270073	BEARING, GLIDE PRO, POWER BRACE	4
3	N/A	1NSG3	16270051	HINGE BUTT, INTERMODAL CONTAINER	2
4	N/A	1NSG3	16270075	LEAF STRAP, INTERMODAL CONTAINER	2
5	N/A	1NSG3	16270082	PIN, HINGE, POWERBRACE, 1/2" x 5- 1/4"	2
1	N/A	1NSG3	CONTACT BOH	COMPLETE DOOR HINGE ASSY TAN	1
2	N/A	1NSG3	16270073	BEARING, GLIDE PRO, POWER BRACE	4
3	N/A	1NSG3	16270051	HINGE BUTT, INTERMODAL CONTAINER	2
4	N/A	1NSG3	16270075	LEAF STRAP, INTERMODAL CONTAINER	2
5	N/A	1NSG3	16270082	PIN, HINGE, POWERBRACE, 1/2" x 5- 1/4"	2
END OF FIGURE 04					

DOOR RETAINING STRAP AND D-RING

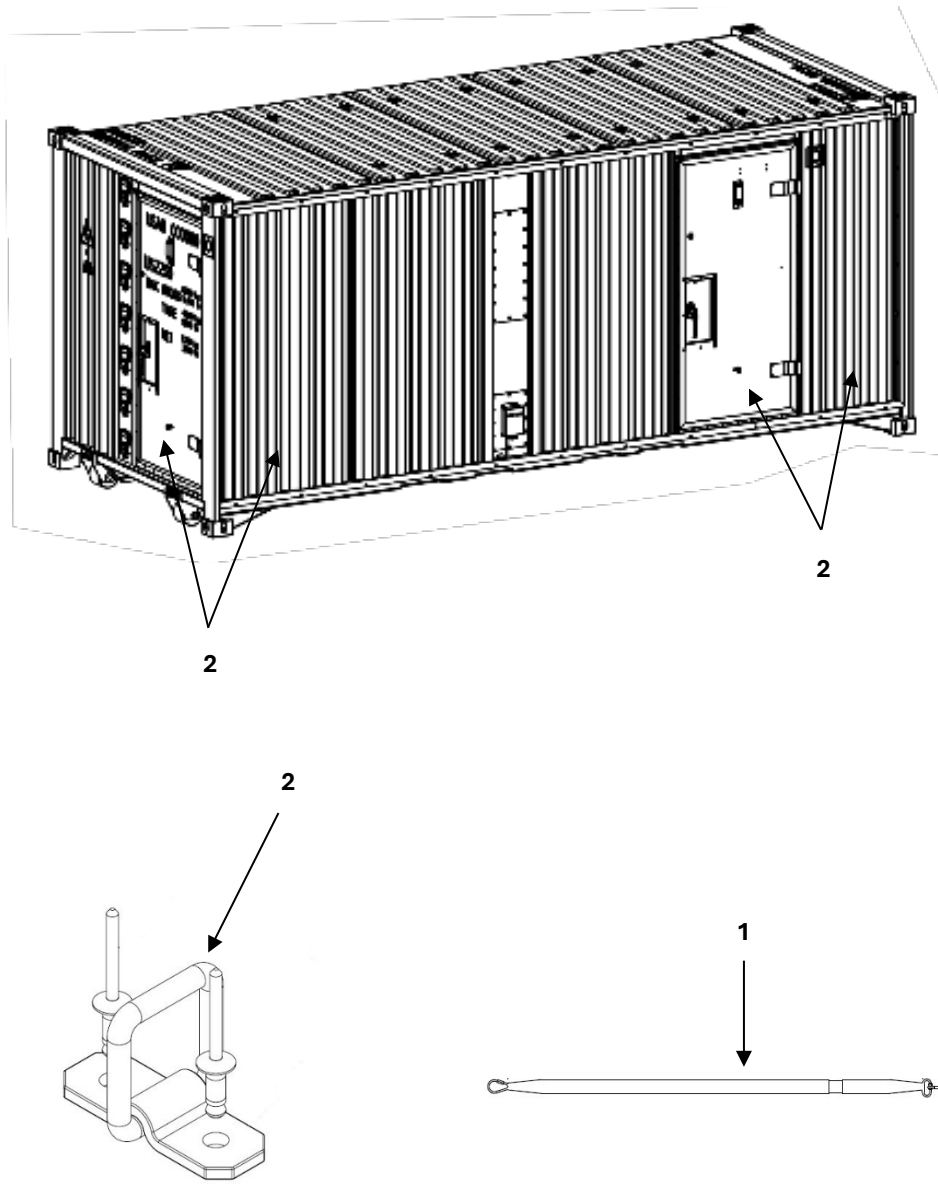

FIGURE 05 – DOOR RETAINING STRAP AND D-RING

(1) ITEM NO.	(2) NSN	(3) CAGEC	(4) PART NUMBER	(5) DESCRIPTION AND USABLE ON CODE (UOC)	(6) QTY
				GROUP 0104 FIGURE 05 DOOR RETAINING STRAP AND D-RING	
1	N/A	1NSG3	CONTACT BOH	DOOR RETAINING STRAP	1
2	N/A	1NSG3	CONTACT BOH	DOOR D-RING ASSY GREEN	1
3	N/A	1NSG3	15940107	D-RING, TIE DOWN, #700-ZN	1
4	N/A	1NSG3	78640304	POP RIVET, 3/16 X 1/4 - AB64 CLD	2
2	N/A	1NSG3	CONTACT BOH	DOOR D-RING ASSY TAN	1
3	N/A	1NSG3	15940107	D-RING, TIE DOWN, #700-ZN	1
4	N/A	1NSG3	78640304	POP RIVET, 3/16 X 1/4 - AB64 CLD	2
END OF FIGURE 05					

EJOC ELECTRIC BOX

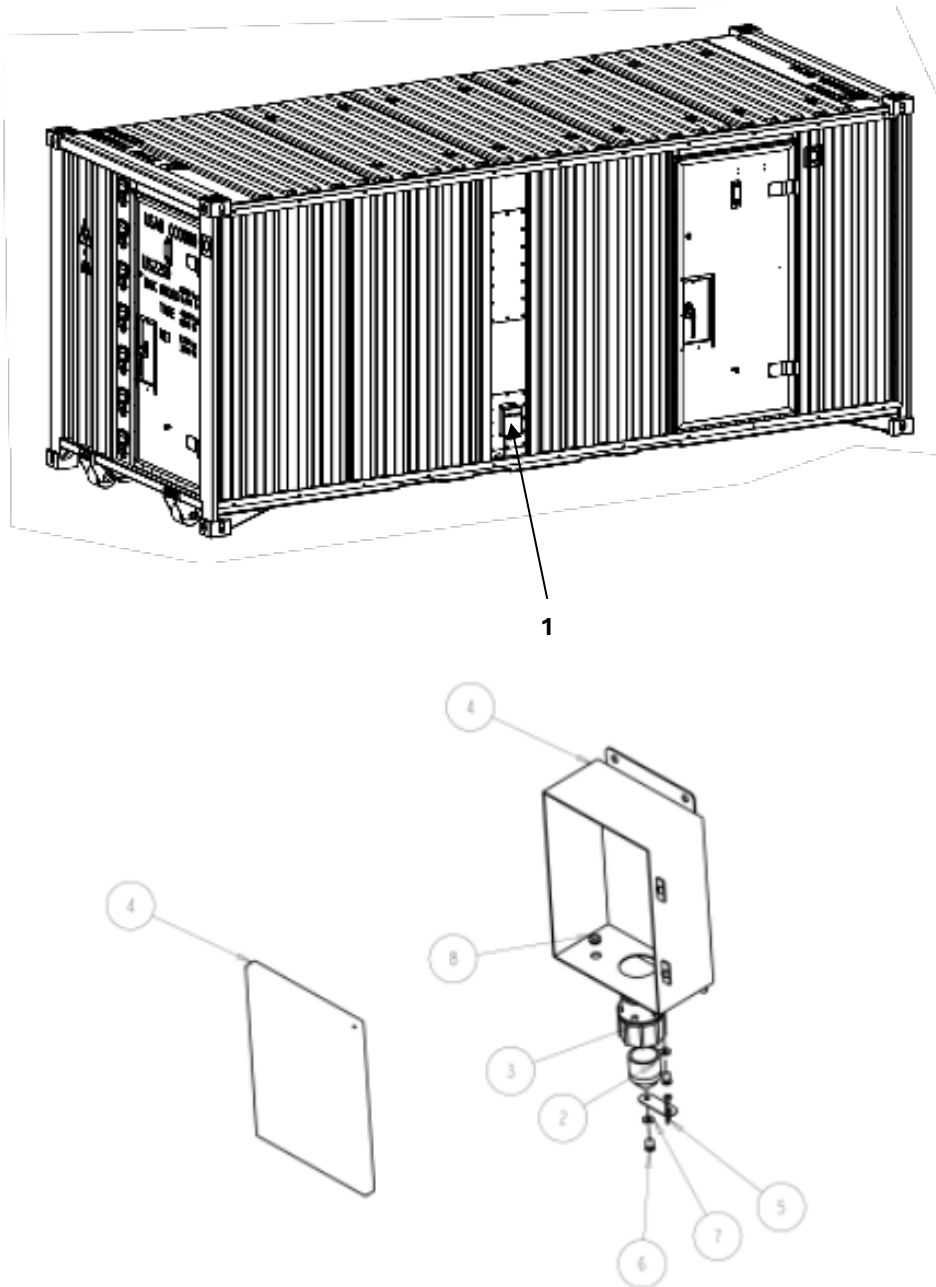

FIGURE 06 – EJOC ELECTRIC BOX

(1) ITEM NO.	(2) NSN	(3) CAGEC	(4) PART NUMBER	(5) DESCRIPTION AND USABLE ON CODE (UOC)	(6) QTY
				GROUP 0105 FIGURE 06 EJOC ELECTRIC BOX ASSEMBLY	
1	N/A	1NSG3	16370151	COMPLETE EJOC ENTRANCE BQX SUB ASSY	1
2	N/A	1NSG3	71032326	CLEANOUT FITTING DWV PLUG I - 1/2"	1
3	N/A	1NSG3	71032226	CONDUIT HB INSULATED THROAT 1-1/2"	1
4	N/A	1NSG3	15220210	ELECTRIC ENCLOSURE NEMA 4X	1
5	N/A	1NSG3	15312267	LANYARD, 6" LONG, EYE ENDS	1
6	N/A	1NSG3	15640324	POP RIVET 3/16 X 1/4" SB64CLD	2
7	N/A	1NSG3	78340108	WASHER-FLAT, CAD PLATED, #8	2
8	N/A	1NSG3	83160006	BUSHING-SNAP IN 3/8" MTD HOLE	1
END OF FIGURE 06					

ROOF TIE-DOWN RING

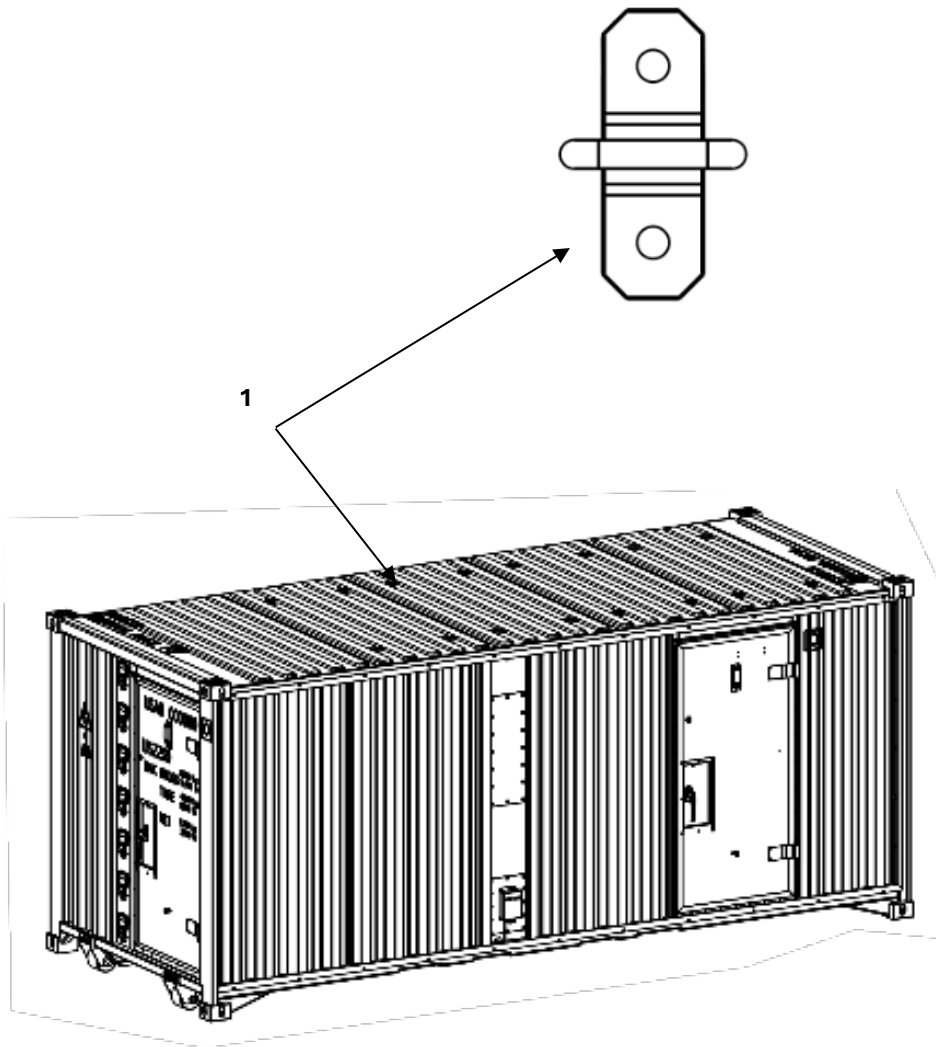

FIGURE 07 – ROOF TIE-DOWN RING

(1) ITEM NO.	(2) NSN	(3) CAGEC	(4) PART NUMBER	(5) DESCRIPTION AND USABLE ON CODE (UOC)	(6) QTY
				GROUP 0106 FIGURE 07 ROOF TIE-DOWN RING	
1	N/A	1NSG3	15940107-001	D-RING, TIE DOWN, #700-ZN GREEN	16
1	N/A	1NSG3	15940107-002	D-RING, TIE DOWN, #700-ZN TAN	16
END OF FIGURE 07					

COMMUNICATIONS INLET

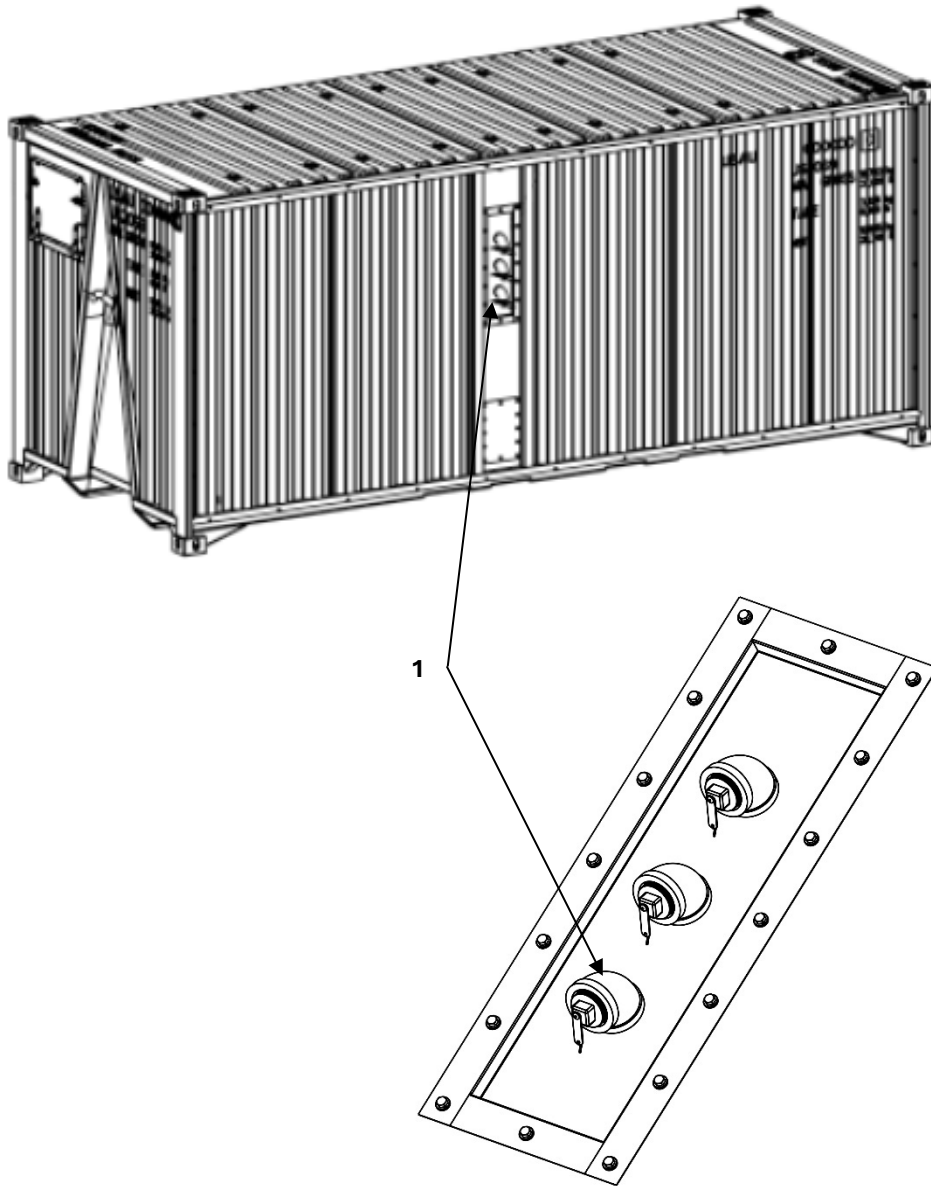

FIGURE 08 – COMMUNICATIONS INLET

(1) ITEM NO.	(2) NSN	(3) CAGEC	(4) PART NUMBER	(5) DESCRIPTION AND USABLE ON CODE (UOC)	(6) QTY
				GROUP 0107 FIGURE 08 COMMS INLET ASSEMBLY	
1	N/A	1NSG3	16190290-001	ELBOW LOCK CAP AND LANYARD ASSEMBLY GREEN	1
1	N/A	1NSG3	16190290-002	ELBOW LOCK CAP AND LANYARD ASSEMBLY TAN	1
END OF FIGURE 08					

HVAC ACCESS DOOR

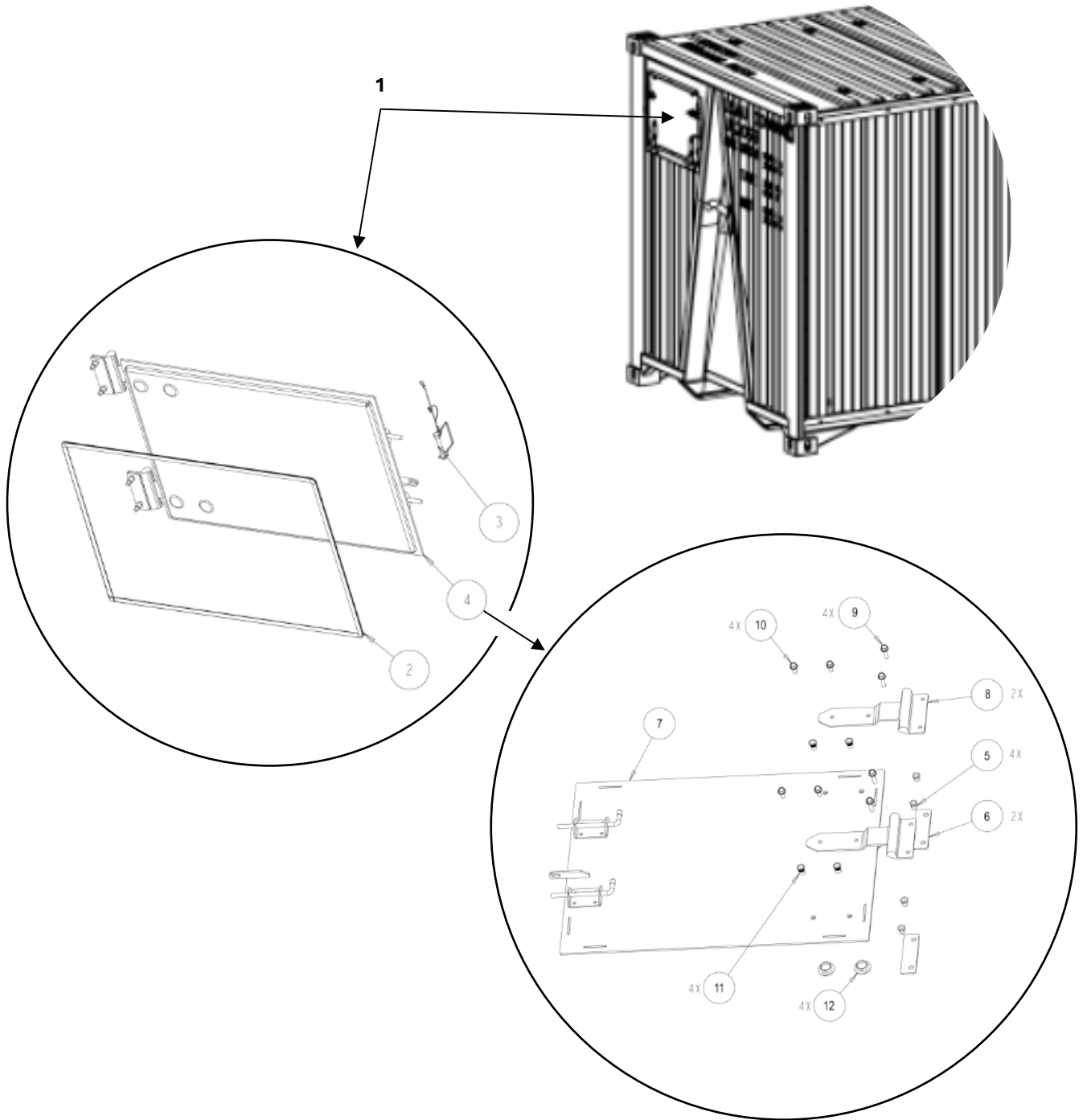

FIGURE 09 – HVAC ACCESS DOOR

(1) ITEM NO.	(2) NSN	(3) CAGEC	(4) PART NUMBER	(5) DESCRIPTION AND USABLE ON CODE (UOC)	(6) QTY
				GROUP 0108 FIGURE 09 COMPLETE HVAC ACCESS DOOR ASSEMBLY	
1	N/A	1NSG3	CONTACT BOH	COMPLETE HVAC ACCESS DOOR ASSEMBLY GREEN	1
2	N/A	1NSG3	16370371	GASKET_HVAC_DOOR_SEAL	1
3	N/A	1NSG3	74022005	PIN-SAFETY SNAP, 3/8 X 2.75, W/ LANYARD	1
4	N/A	1NSG3	16370500	HVAC_DOOR_TOP_ASSM	1
5	N/A	1NSG3	16270097	HEX RIV-NUT, OPEN END, 5/16-18, .027-.150" GRIP	4
6	N/A	1NSG3	16370359	HVAC DOOR HINGE SPACER	2
7	N/A	1NSG3	16370060	EJOC HVAC DOOR WLDMT	1
8	N/A	1NSG3	747070410	POLAR HINGE MODEL #3508, STEEL, ZP	2
9	N/A	1NSG3	78350148	SCREW HEX FLG 5/16-18 X 1- 1/4"	4
10	N/A	1NSG3	78850354	SCREW HEX FLG 5/16-18 X 3/4"	2
11	N/A	1NSG3	78350310	RIVNUT, 5/16-18, .127-.312" GRIP, ZP	4
12	N/A	1NSG3	83120139	PLASTIC ROUND CAP 1" DIA	4
1	N/A	1NSG3	CONTACT BOH	COMPLETE HVAC ACCESS DOOR ASSEMBLY TAN	1
2	N/A	1NSG3	16370371	GASKET_HVAC_DOOR_SEAL	1
3	N/A	1NSG3	74022005	PIN-SAFETY SNAP, 3/8 X 2.75, W/ LANYARD	1
4	N/A	1NSG3	16370500	HVAC_DOOR_TOP_ASSM	1
5	N/A	1NSG3	16270097	HEX RIV-NUT, OPEN END, 5/16-18, .027-.150" GRIP	4
6	N/A	1NSG3	16370359	HVAC DOOR HINGE SPACER	2
7	N/A	1NSG3	16370060	EJOC HVAC DOOR WLDMT	1
8	N/A	1NSG3	747070410	POLAR HINGE MODEL #3508, STEEL, ZP	2
9	N/A	1NSG3	78350148	SCREW HEX FLG 5/16-18 X 1- 1/4"	4
10	N/A	1NSG3	78850354	SCREW HEX FLG 5/16-18 X 3/4"	2
11	N/A	1NSG3	78350310	RIVNUT, 5/16-18, .127-.312" GRIP, ZP	4
12	N/A	1NSG3	83120139	PLASTIC ROUND CAP 1" DIA	4
END OF FIGURE 09					

END OF WORKPACKAGE

PARTS SUPPORTING INFORMATION
BOH SOLUTIONS OPERATION MANUAL
(INCLUDING REPAIR PARTS)
EXPEDITIONARY JOINT OPERATIONS CENTER (EJOC®)

INTERIOR REPAIR PARTS

EXPEDITIONARY JOINT OPERATIONS CENTER (EJOC)

EJOC DESK WALL - FIGURES 10 to 17

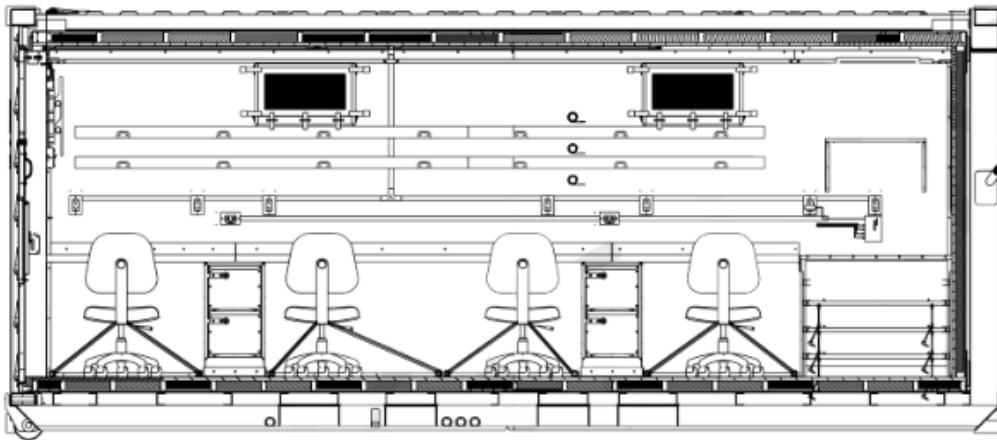

EJOC UTILITIES WALL - FIGURES 18 to 00

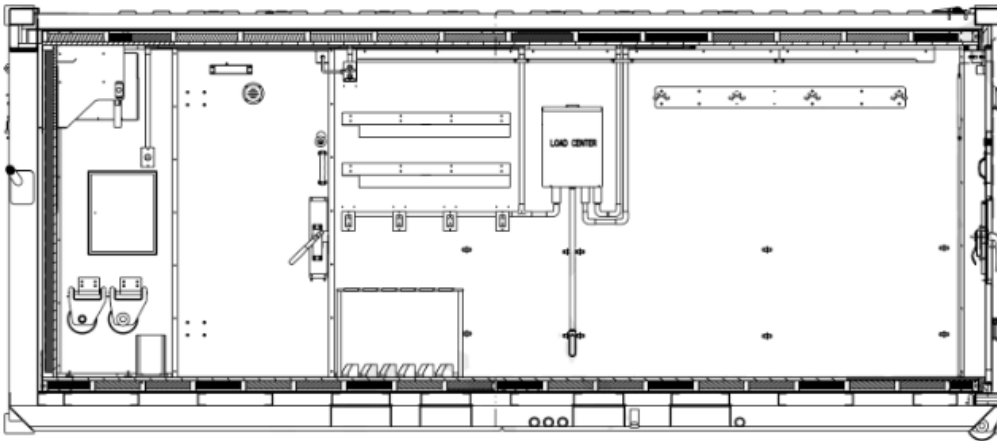

TOP CABINET

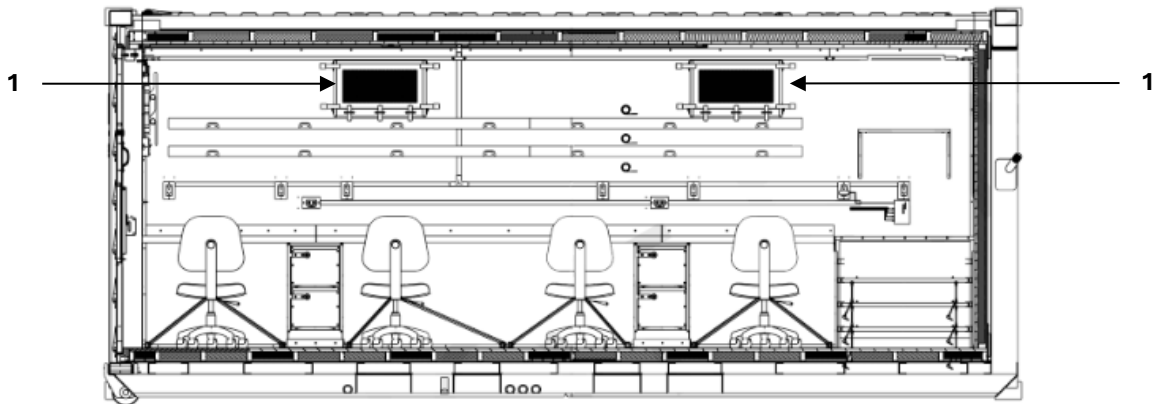
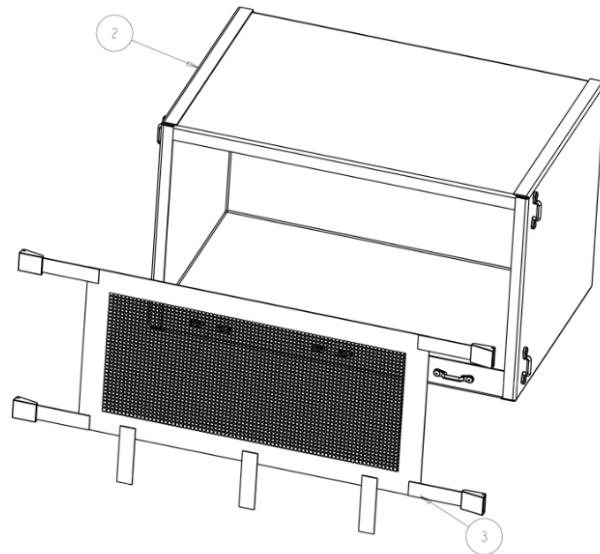

FIGURE 10 – TOP CABINET

(1) ITEM NO.	(2) NSN	(3) CAGEC	(4) PART NUMBER	(5) DESCRIPTION AND USABLE ON CODE (UOC)	(6) QTY
				GROUP 0109 FIGURE 10 COMPLETE TOP CABINET ASSEMBLY	
1	N/A	1NSG3	CONTACT BOH	COMPLETE TOP CABINET ASSEMBLY	1
2	N/A	1NSG3	CONTACT BOH	TOP CABINET ASSEMBLY	1
3	N/A	1NSG3	16370307	CABINET NET	1
END OF FIGURE 10					

FILE CABINET

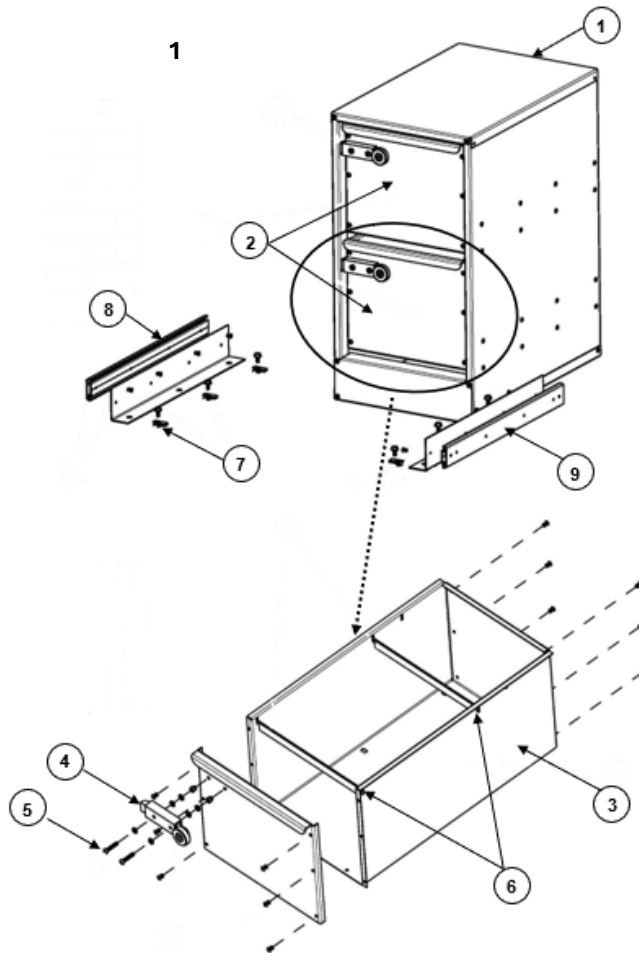
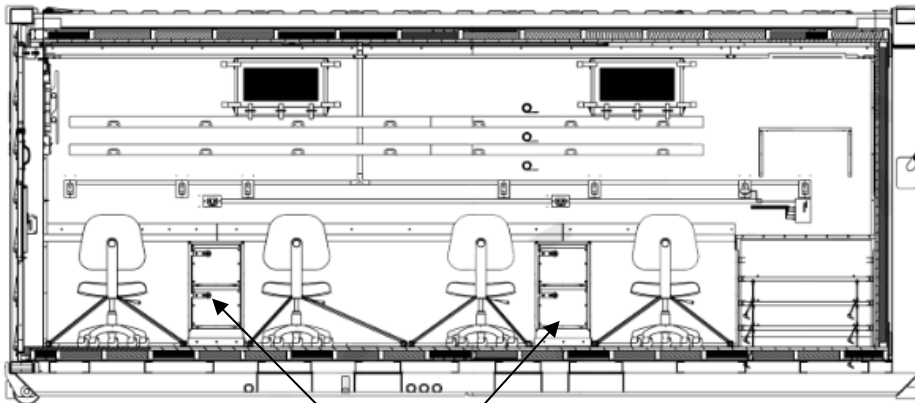

FIGURE 11 – FILE CABINET

(1) ITEM NO.	(2) NSN	(3) CAGEC	(4) PART NUMBER	(5) DESCRIPTION AND USABLE ON CODE (UOC)	(6) QTY
				GROUP 0110 FIGURE 11 COMPLETE FILE CABINET ASSEMBLY	
1	N/A	1NSG3	CONTACT BOH	FILE CABINET ASSEMBLY	1
2	N/A	1NSG3	15988506	DRAWER ASSEMBLY KIT W/ HDW.	2
3	N/A	1NSG3	NA	DRAWER BODY	1
4	N/A	1NSG3	15988356	SLAM LATCH ASSEMBLY W/ HDW.	1
5	N/A	1NSG3	NA	SLAM LATCH HARDWARE KIT	1
6	N/A	1NSG3	NA	CROSSBAR	2
7	N/A	1NSG3	15988354	FILE CABINET DRAWER KIT W/ HDW.	2
8	N/A	1NSG3	15988508	DRAWER SLIDE ASSEMBLY KIT - LEFT	2
9	N/A	1NSG3	15988507	DRAWER SLIDE ASSEMBLY KIT - RIGHT	2
END OF FIGURE 11					

3 SHELF CABINET

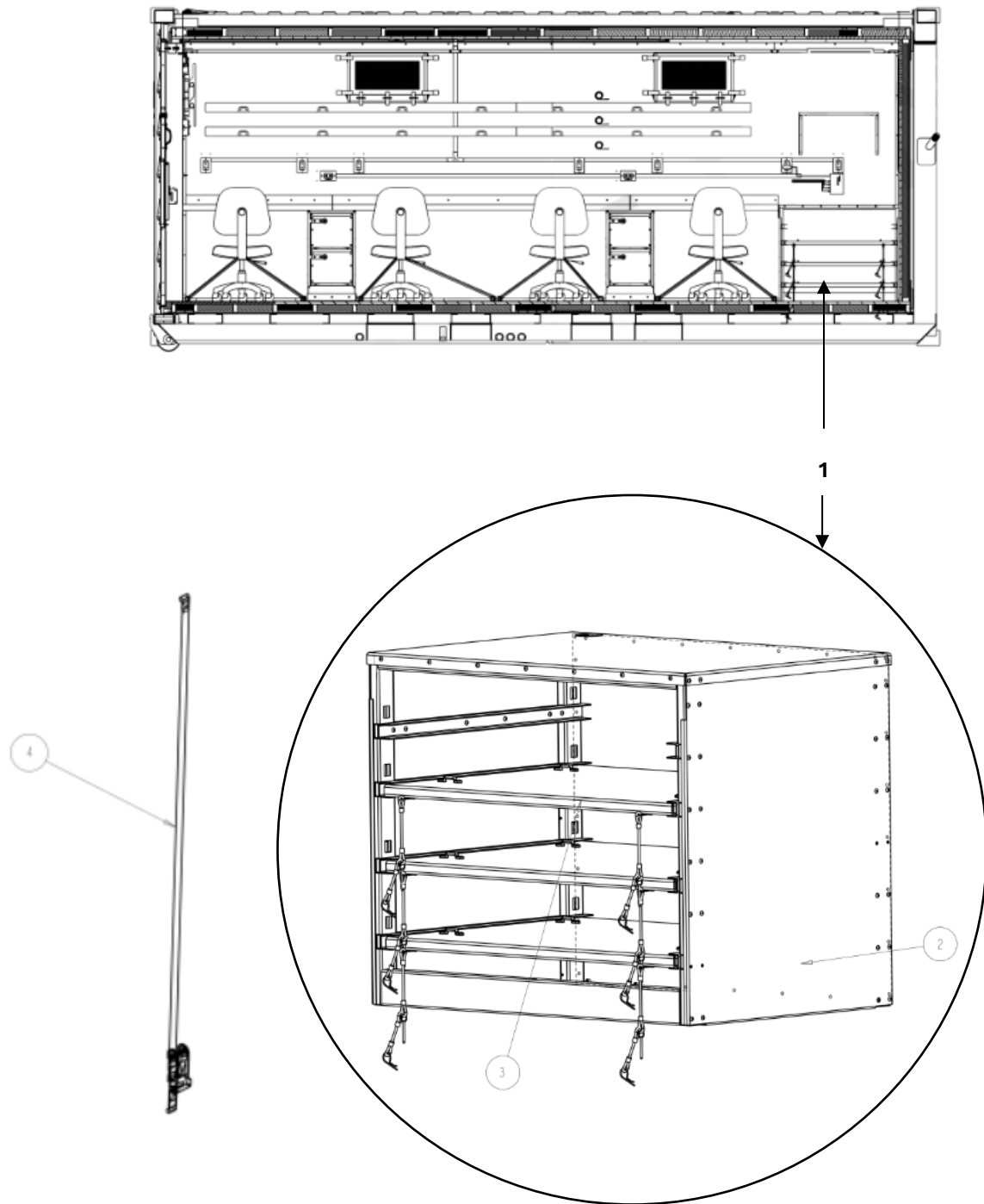

FIGURE 12 – FILE CABINET

(1) ITEM NO.	(2) NSN	(3) CAGEC	(4) PART NUMBER	(5) DESCRIPTION AND USABLE ON CODE (UOC)	(6) QTY
				GROUP 0111 FIGURE 12 COMPLETE 3 SHELF CABINET ASSEMBLY	
1	N/A	1NSG3	CONTACT BOH	3 SHELF CABINET ASSEMBLY	1
2	N/A	1NSG3		3 SHELF CABINET BODY ASSEMBLY	1
3	N/A	1NSG3	16370313	SHELF ASSEMBLY	3
4	N/A	1NSG3	16370331	SERVER AND OVERHEAD STRAP	6
END OF FIGURE 12					

PRINTER TRAY

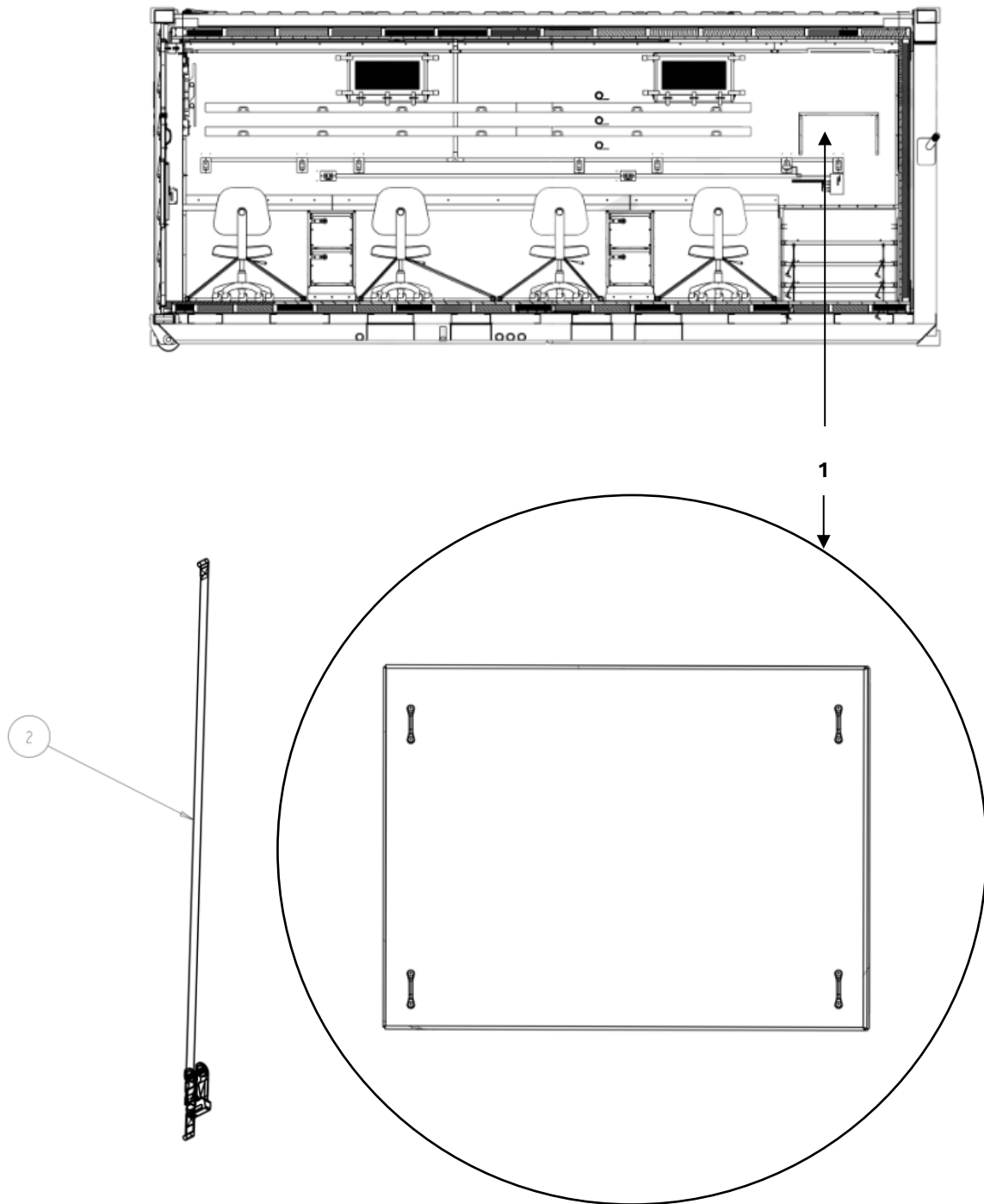
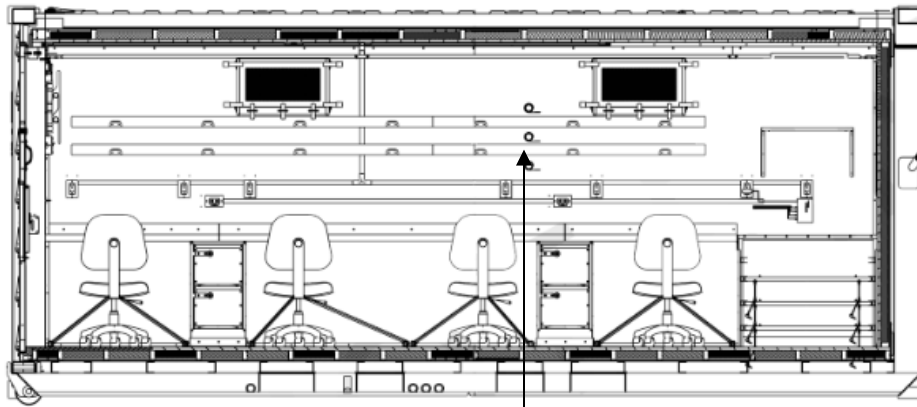

FIGURE 13 – PRINTER TRAY

(1) ITEM NO.	(2) NSN	(3) CAGEC	(4) PART NUMBER	(5) DESCRIPTION AND USABLE ON CODE (UOC)	(6) QTY
				GROUP 0112 FIGURE 13 PRINTER TRAY ASSEMBLY	
1	N/A	1NSG3	CONTACT BOH	PRINTER TRAY ASSEMBLY	1
2	N/A	1NSG3	16370331	SERVER AND OVERHEAD STRAP	2
END OF FIGURE 13					

COMMS INLET SLEEVE



1

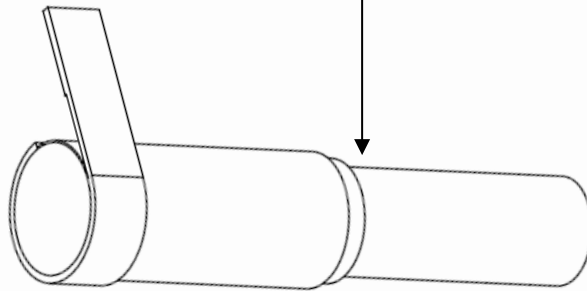

FIGURE 14 – COMMS INLET SLEEVE

(1) ITEM NO.	(2) NSN	(3) CAGEC	(4) PART NUMBER	(5) DESCRIPTION AND USABLE ON CODE (UOC)	(6) QTY
				GROUP 0113 FIGURE 14 COMMS INLET SLEEVE ASSEMBLY	
1	N/A	1NSG3	16370275	COMMS INLET SLEEVE ASSEMBLY	1
END OF FIGURE 14					

DESKTOP

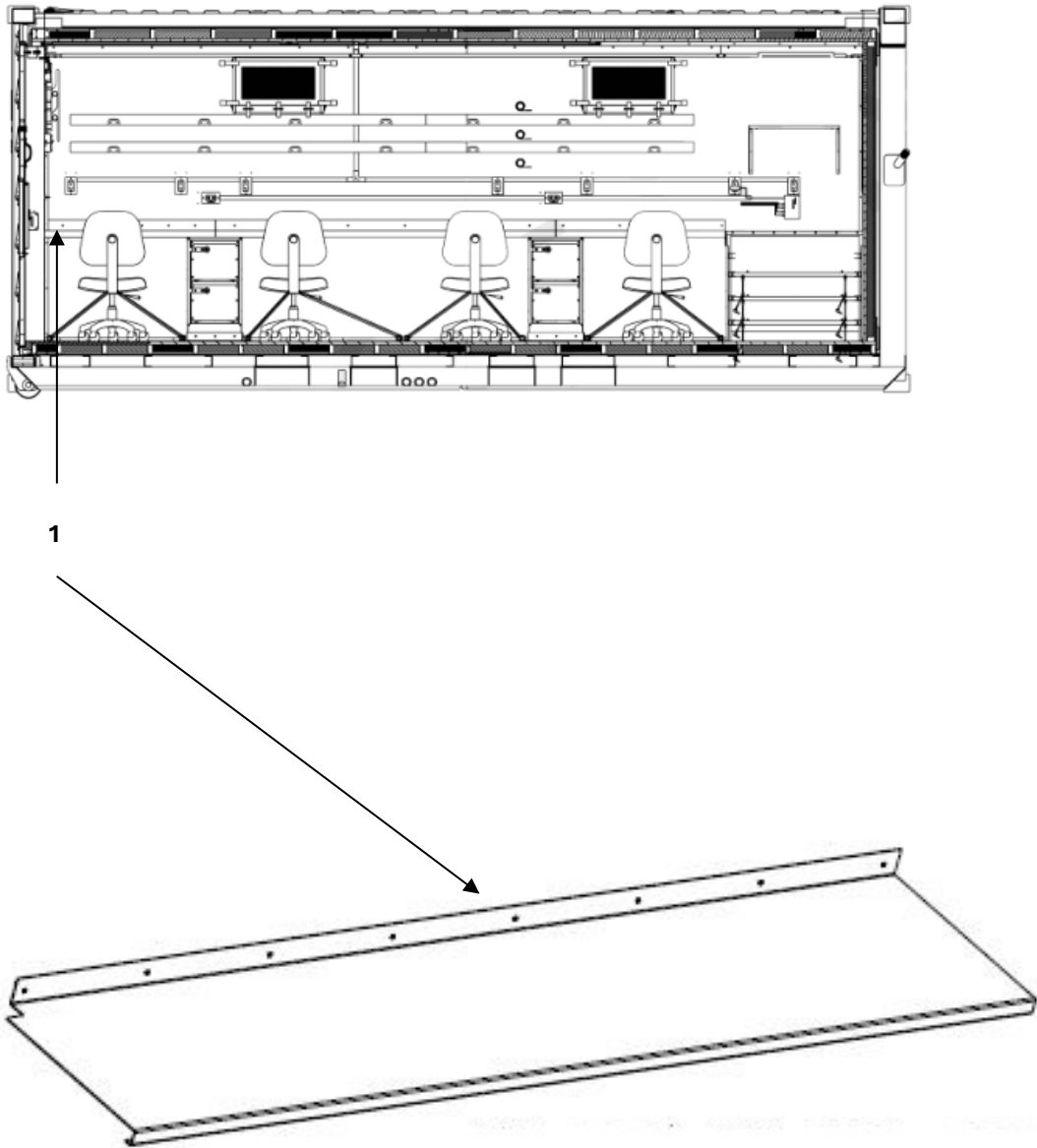

FIGURE 15 – DESKTOP

(1) ITEM NO.	(2) NSN	(3) CAGEC	(4) PART NUMBER	(5) DESCRIPTION AND USABLE ON CODE (UOC)	(6) QTY
				GROUP 0114 FIGURE 15 DESK ASSEMBLY	
1	N/A	1NSG3	CONTACT BOH	DESK ASSEMBLY W/ MTG. HDW	1
END OF FIGURE 15					

WALL COMPONENTS

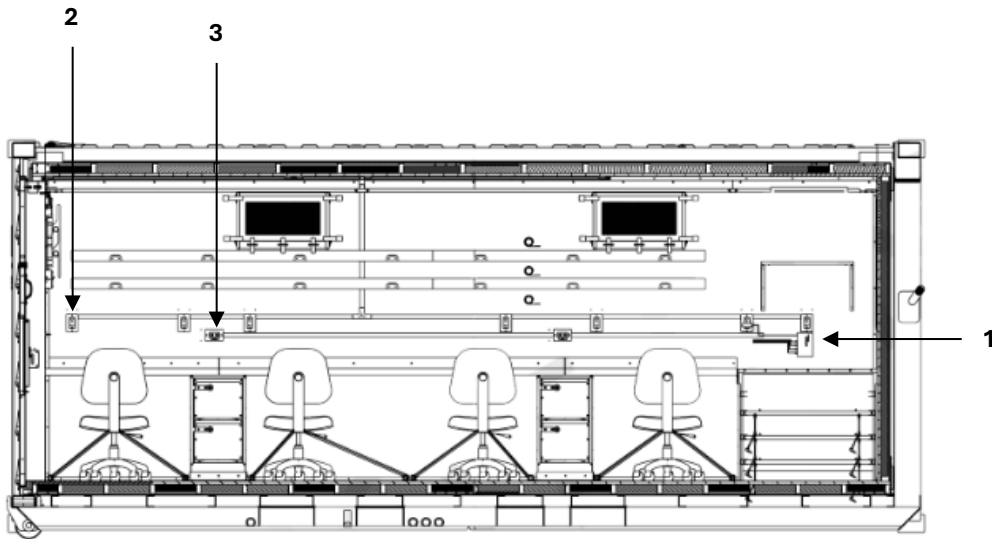

FIGURE 16 – WALL COMPONENTS

(1) ITEM NO.	(2) NSN	(3) CAGEC	(4) PART NUMBER	(5) DESCRIPTION AND USABLE ON CODE (UOC)	(6) QTY
				GROUP 0115 FIGURE 16 DESK ASSEMBLY	
1	N/A	1NSG3	CONTACT BOH	NETWORK SWITCH	1
2	N/A	1NSG3	15988752	SURGE RECEPTACLE BLUE W/ WALL PLATE AND HDW.	1
3	N/A	1NSG3	16190153	CAT-5 DUPLEX OUTLET	1
END OF FIGURE 16					

DESK PARTS

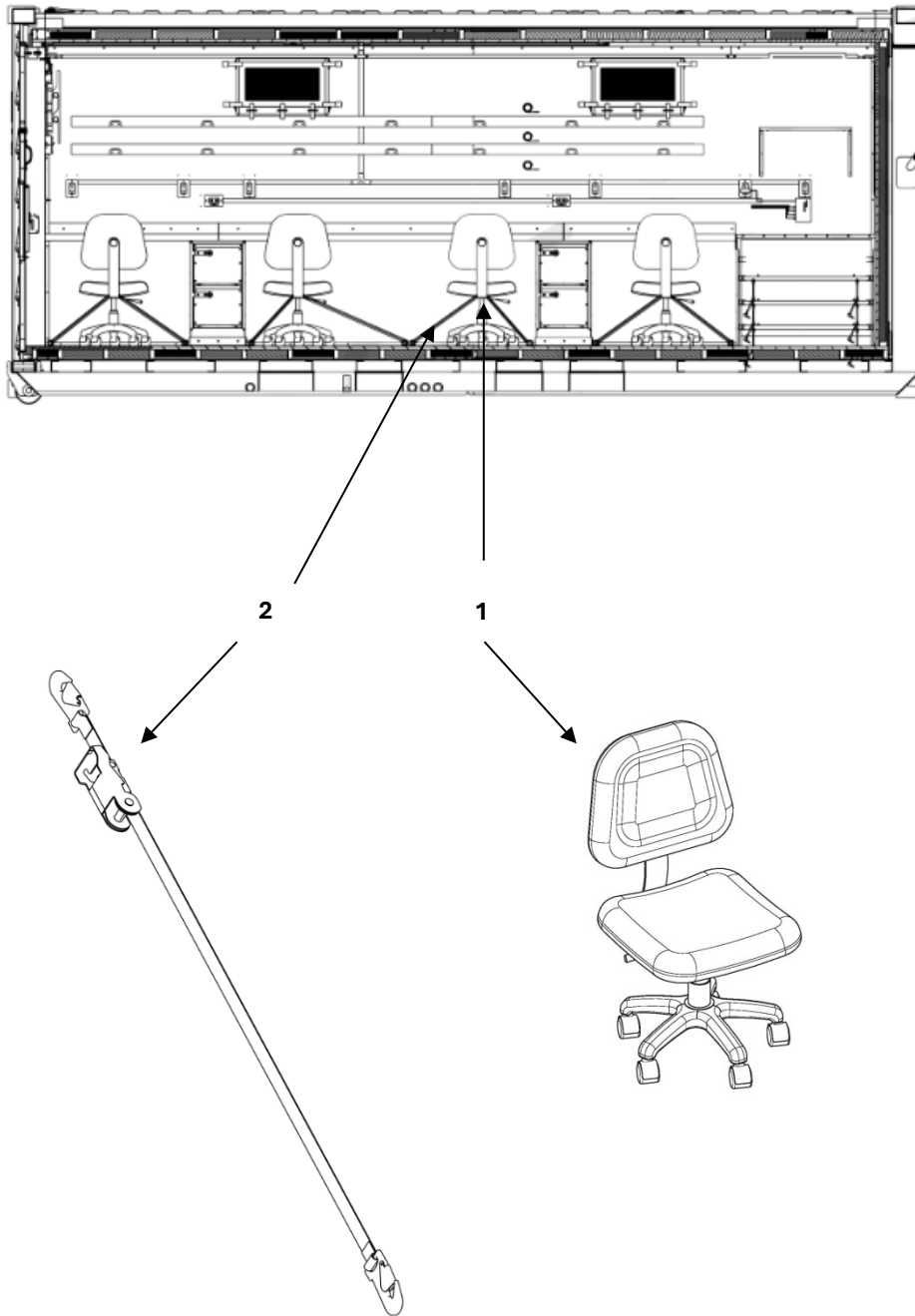

FIGURE 17 – DESK PARTS

(1) ITEM NO.	(2) NSN	(3) CAGEC	(4) PART NUMBER	(5) DESCRIPTION AND USABLE ON CODE (UOC)	(6) QTY
				GROUP 0116 FIGURE 17 DESK PARTS	
1	N/A	1NSG3	CONTACT BOH	SWIVEL DESK CHAIR	1
2	N/A	1NSG3	16370338	CHAIR STRAP FOR EJOC	1
END OF FIGURE 17					

TACTICAL GEAR HOOKS

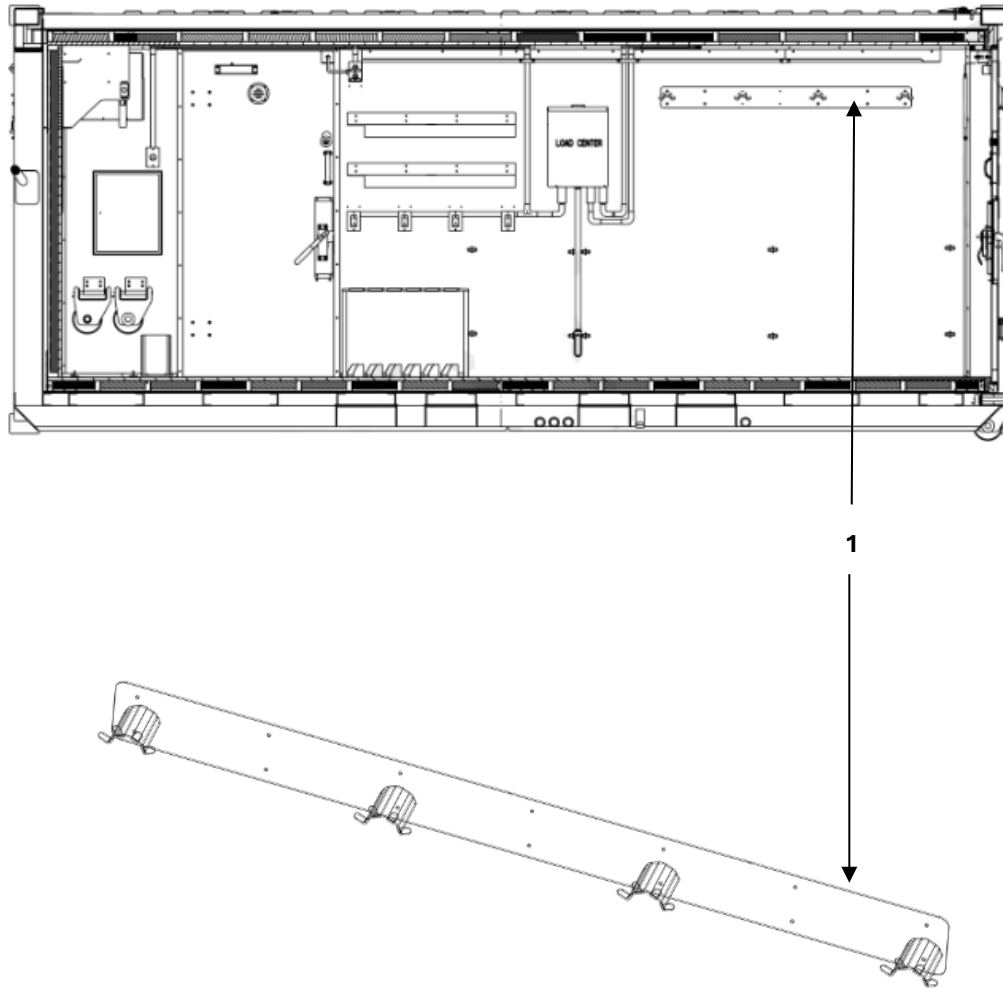

FIGURE 18 – TACTICAL GEAR HOOKS

(1) ITEM NO.	(2) NSN	(3) CAGEC	(4) PART NUMBER	(5) DESCRIPTION AND USABLE ON CODE (UOC)	(6) QTY
				GROUP 0117 FIGURE 18 TACTICAL GEAR HOOKS	
1	N/A	1NSG3	16370901	TACTICAL GEAR HOOKS WITH HDW.	1
END OF FIGURE 18					

WEAPONS RACK

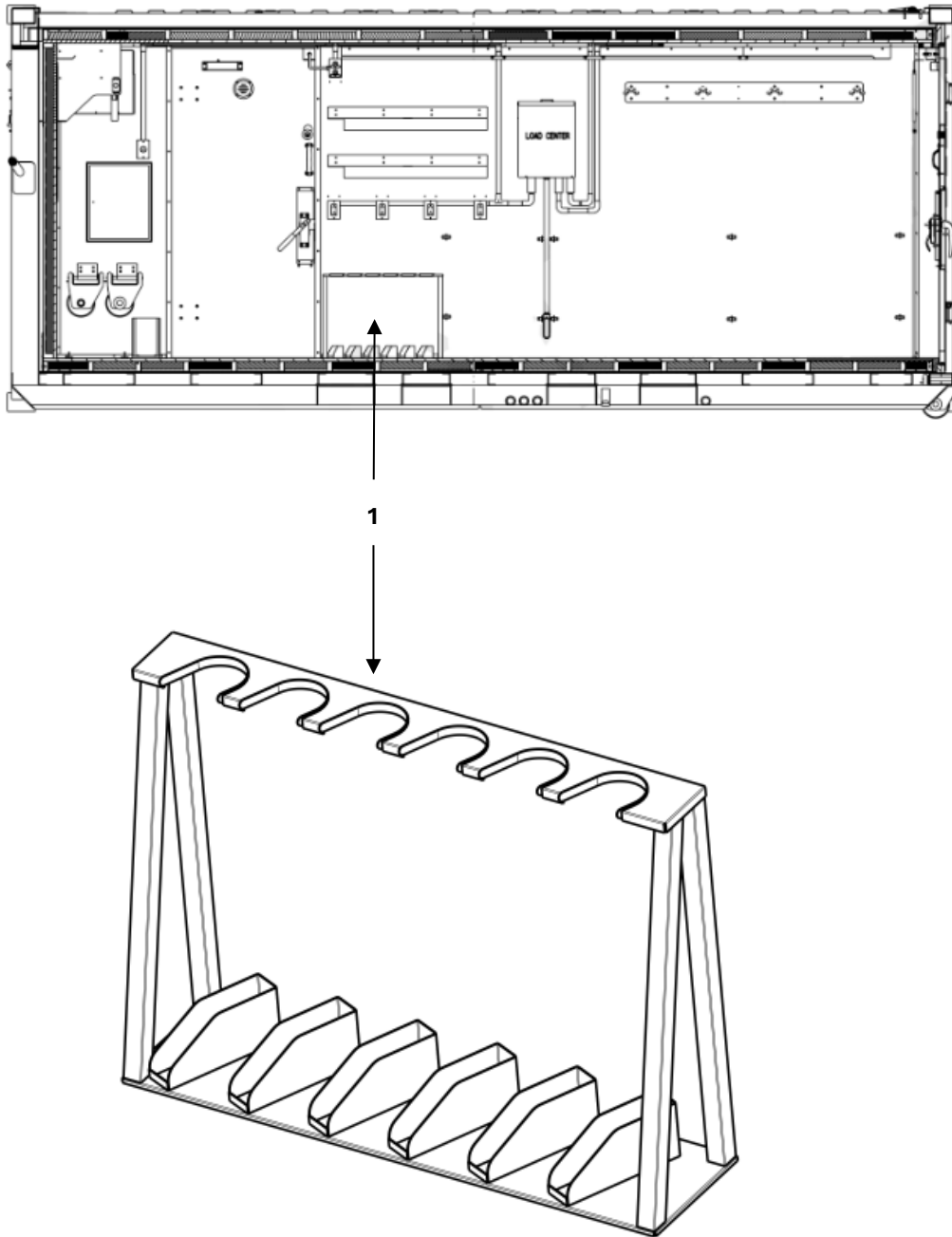

FIGURE 19 – WEAPONS RACK

(1) ITEM NO.	(2) NSN	(3) CAGEC	(4) PART NUMBER	(5) DESCRIPTION AND USABLE ON CODE (UOC)	(6) QTY
				GROUP 0118 FIGURE 19 TACTICAL GEAR HOOKS	
1	N/A	1NSG3	16370902	WEAPONS RACK	1
END OF FIGURE 19					

REAR ROLLER ASSEMBLY

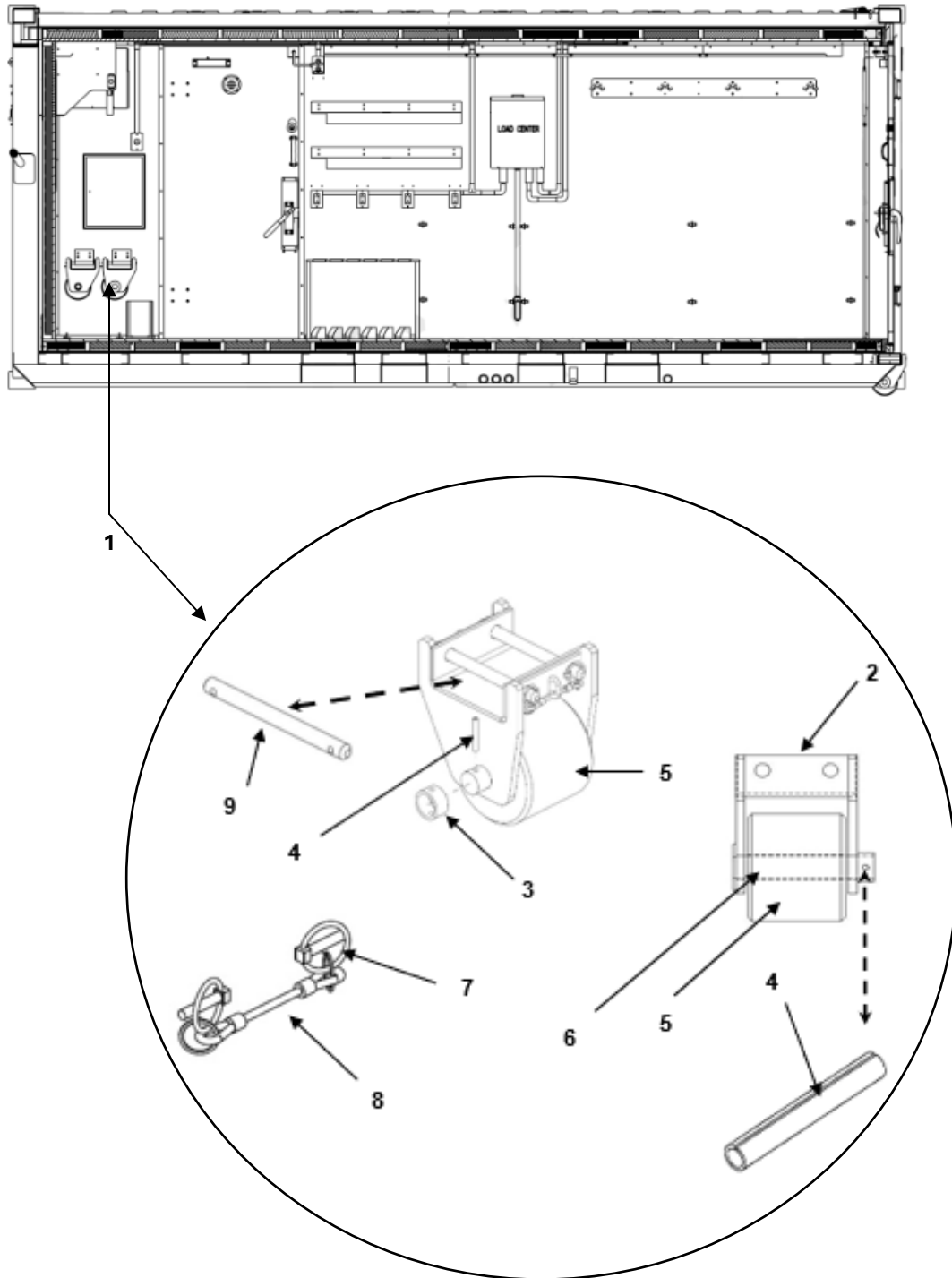

FIGURE 20 – REAR ROLLER ASSEMBLY

(1) ITEM NO.	(2) NSN	(3) CAGEC	(4) PART NUMBER	(5) DESCRIPTION AND USABLE ON CODE (UOC)	(6) QTY
				GROUP 0119 FIGURE 20 REAR ROLLER ASSEMBLY	
1	5411-01-529-9175	1NSG3	15310001-001	ROLLER ASSY. GREEN	2
2	N/A	1NSG3	16500954-001	FRAME, ROLLER GREEN	1
3	5411-01-529-9180	1NSG3	15312286	COLLAR, SHAFT 1 ½" ID	1
4	N/A	1NSG3	15312225	PIN, ROLLED 5/16" x2 ¼"	1
5	5411-01-529-9177	1NSG3	16500903	ROLLER, BLACK	1
6	5411-01-529-9178	1NSG3	16500950	PIN, ROLLER	1
7	N/A	1NSG3	15312262	PIN, LINCH ¼"	2
8	5411-01-529-9190	1NSG3	16500955	PIN LANYARD ASSY	4
9	5411-01-529-9179	1NSG3	16500905	ROLLER ATTACHING PIN	2
1	5411-01-529-9175	1NSG3	15310001-002	ROLLER ASSY. TAN	2
2	N/A	1NSG3	16500954-002	FRAME, ROLLER TAN	1
3	5411-01-529-9180	1NSG3	15312286	COLLAR, SHAFT 1 ½" ID	1
4	N/A	1NSG3	15312225	PIN, ROLLED 5/16" x2 ¼"	1
5	5411-01-529-9177	1NSG3	16500903	ROLLER, BLACK	1
6	5411-01-529-9178	1NSG3	16500950	PIN, ROLLER	1
7	N/A	1NSG3	15312262	PIN, LINCH ¼"	2
8	5411-01-529-9190	1NSG3	16500955	PIN LANYARD ASSY	4
9	5411-01-529-9179	1NSG3	16500905	ROLLER ATTACHING PIN	2
END OF FIGURE 20					

WALL D-RINGS AND STRAPS

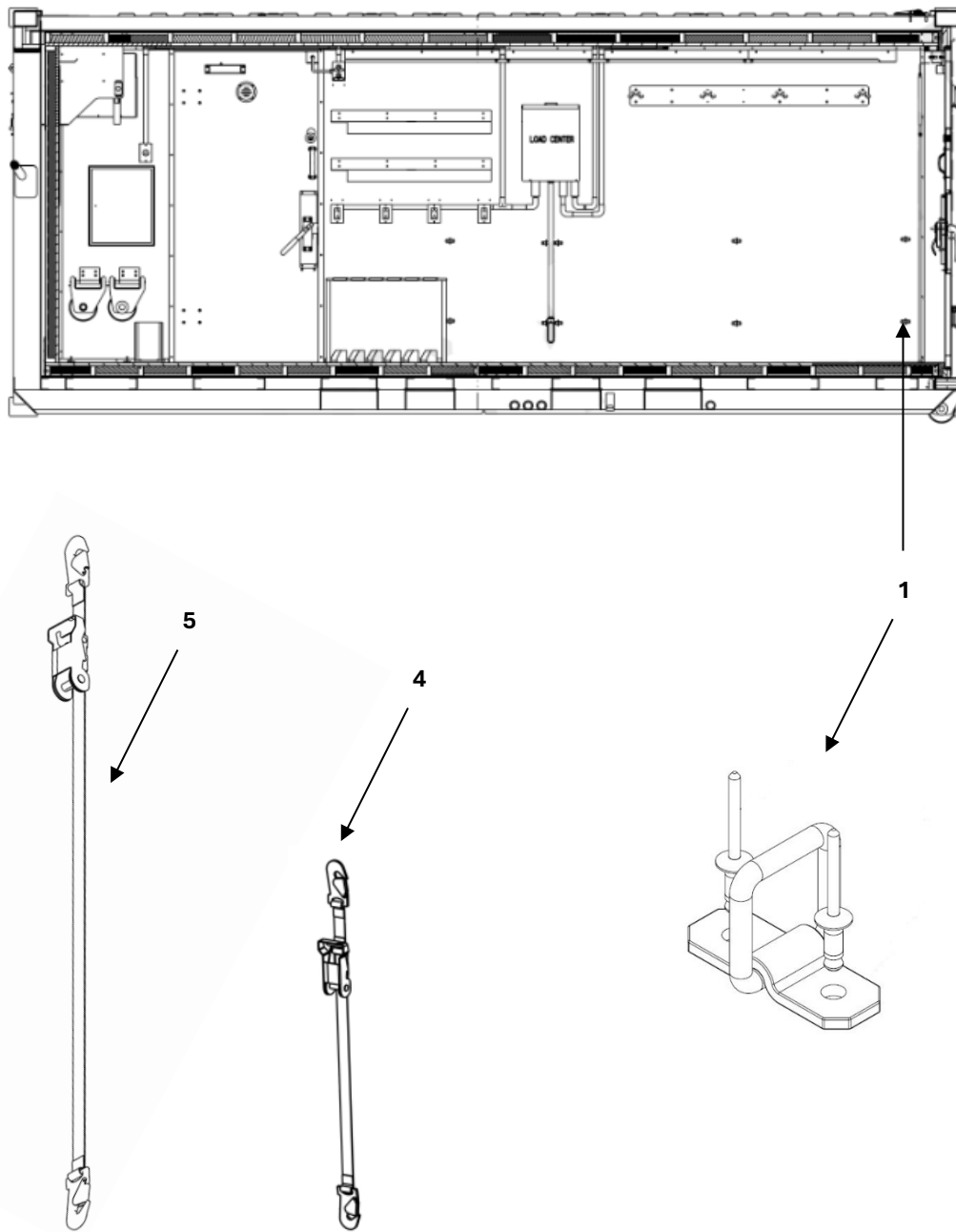

FIGURE 21 – WALL D-RINGS AND STRAPS

(1) ITEM NO.	(2) NSN	(3) CAGEC	(4) PART NUMBER	(5) DESCRIPTION AND USABLE ON CODE (UOC)	(6) QTY
				GROUP 0120 FIGURE 21 WALL D-RINGS AND STRAPS	
1	N/A	1NSG3	CONTACT BOH	DOOR D-RING ASSY GREEN	1
2	N/A	1NSG3	15940107	D-RING, TIE DOWN, #700-ZN	1
3	N/A	1NSG3	78640304	POP RIVET, 3/16 X 1/4 - AB64 CLD	2
4	N/A	1NSG3	16370334	WALL STRAP SHORT	1
5	N/A	1NSG3	16370341	WALL STRAP LONG	1
END OF FIGURE 21					

LIGHTING INTERRUPTER DOOR SWITCH

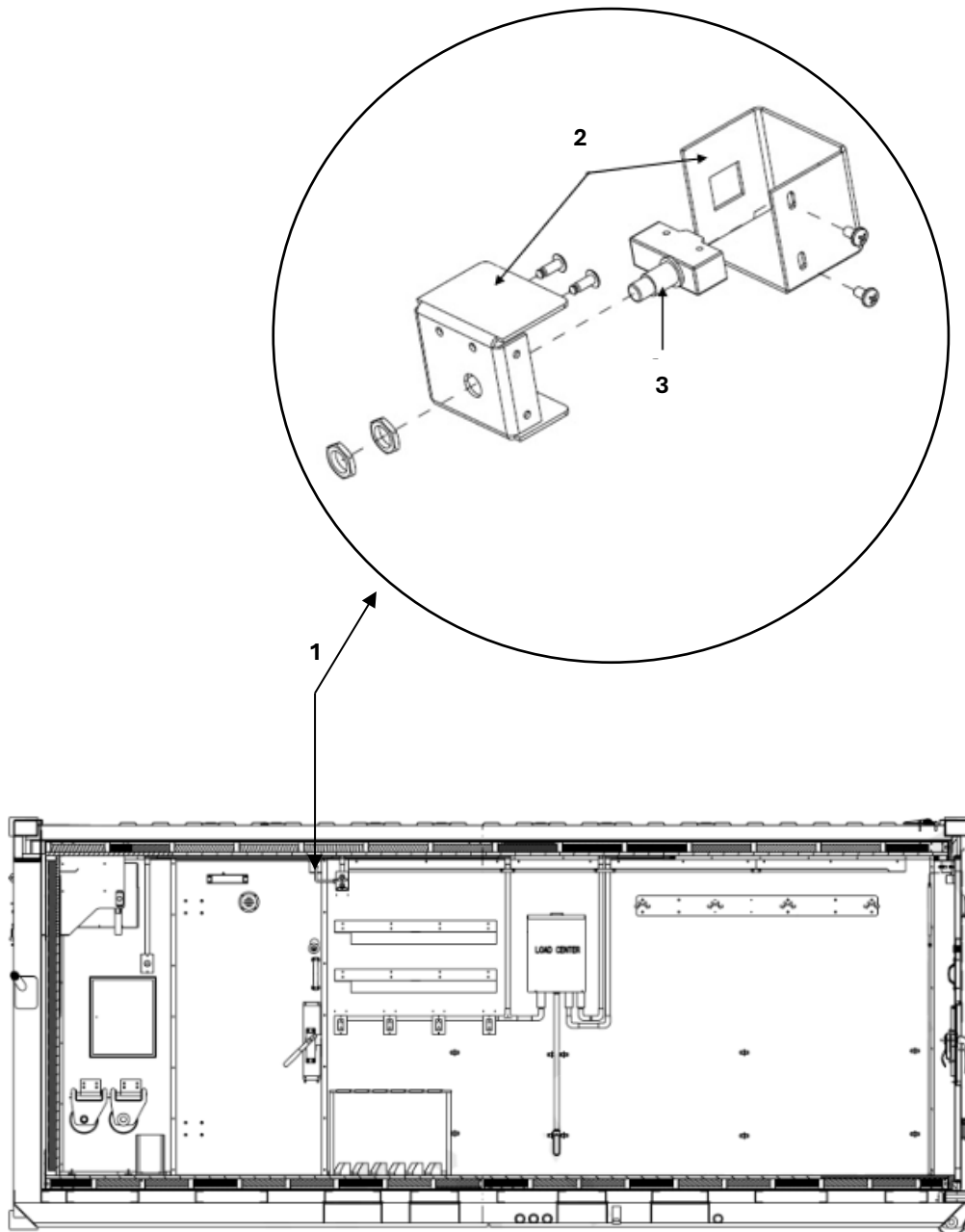

FIGURE 22 – LIGHTING INTERRUPTER DOOR SWITCH

(1) ITEM NO.	(2) NSN	(3) CAGEC	(4) PART NUMBER	(5) DESCRIPTION AND USABLE ON CODE (UOC)	(6) QTY
				GROUP 0121 FIGURE 22 LIGHTING INTERRUPTER DOOR SWITCH	
1	N/A	1NSG3	CONTACT BOH	LIGHTING INTERRUPTER DOOR SWITCH ASSY	1
2	N/A	1NSG3	15988476	DOOR SWITCH MOUNTING BRACKET W/HDWR KIT	2
3	N/A	1NSG3	72270504	SWITCH W/HDWR OMRON #20GQ-B	1
END OF FIGURE 22					

EJOC HVAC AND COMPLETE HOUSING ASSEMBLY

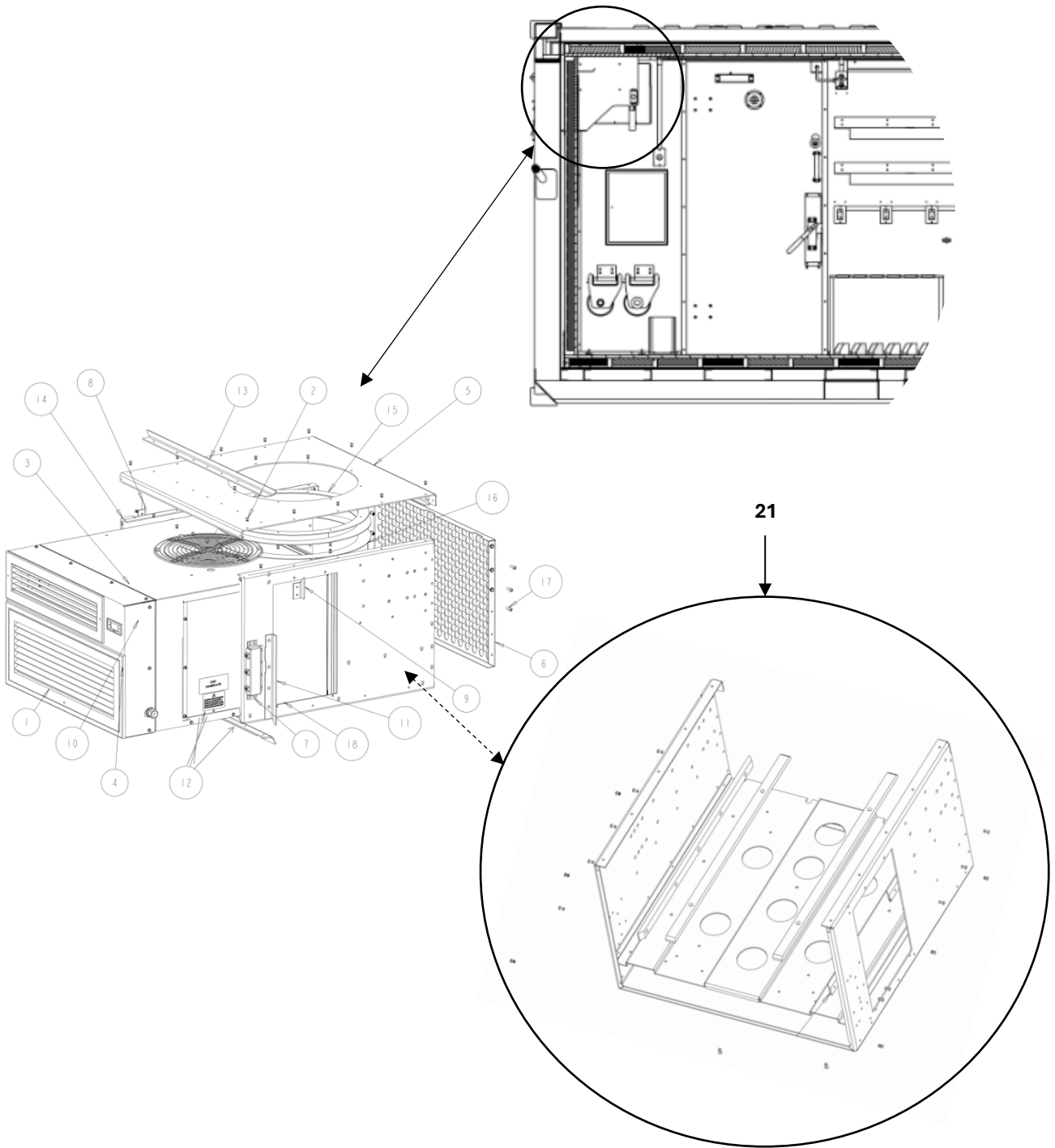

FIGURE 23 – EJOC HVAC AND COMPLETE HOUSING ASSEMBLY

(1) ITEM NO.	(2) NSN	(3) CAGEC	(4) PART NUMBER	(5) DESCRIPTION AND USABLE ON CODE (UOC)	(6) QTY
				GROUP 0122 FIGURE 23 EJOC HVAC AND COMPLETE HOUSING ASSEMBLY	
1	N/A	1NSG3	15220825-002	EJOC NORTHERN-AIR HVAC	1
2	N/A	1NSG3	15640305	POP RIVET, 3/16 X 1/4 - SB64	55
3	N/A	1NSG3	15640306	RIVET, 3/16 X 3/8 GRIP STEEL - SB66	16
4	N/A	1NSG3	16370200	EJOC INTEGRATED CVR ASSM	1
5	N/A	1NSG3	16370220	EJOC HVAC TOP CVR	1
6	N/A	1NSG3	16370250	EJOC HVAC GRILLE ASSM	1
7	N/A	1NSG3	16370286	LOCKING BRACKET ASSEMBLY	2
8	N/A	1NSG3	16370351	HVAC TOP LH SEAL FLANGE	1
9	N/A	1NSG3	16370352	HVAC TOP RH SEAL FLANGE	1
10	N/A	1NSG3	16370353	HVAC LH SEAL FLANGE	1
11	N/A	1NSG3	16370354	HVAC RH SEAL FLANGE	1
12	N/A	1NSG3	16370355	HVAC BTM LH SEAL FLANGE	1
13	N/A	1NSG3	16370356	HVAC BTM RH SEAL FLANGE	1
14	N/A	1NSG3	16370357	HVAC TOP SEAL FLANGE	1
15	N/A	1NSG3	16370369	GASKET FOAM 1-1/4" X 1/2" W/ADH	4
16	N/A	1NSG3	16370650	EJOC HVAC EXHAUST WLDMT	1
17	N/A	1NSG3	16370654	EJOC HVAC EXHAUST GASKET	1
18	N/A	1NSG3	78674004	SCREW, TORX, 1/4-20X3/4" ALLOY	6
19	N/A	1NSG3	78674030	POP RIVET 1/4 X 1/4 SB66	7
20	N/A	1NSG3	83120139	PLASTIC ROUND CAP 1" DIA	2
21	N/A	1NSG3	16370200	EJOC INTERGRATED CVR ASSM	1
END OF FIGURE 23					

EJOC HVAC SLIDES AND COMPLETE SHROUD ASSEMBLY

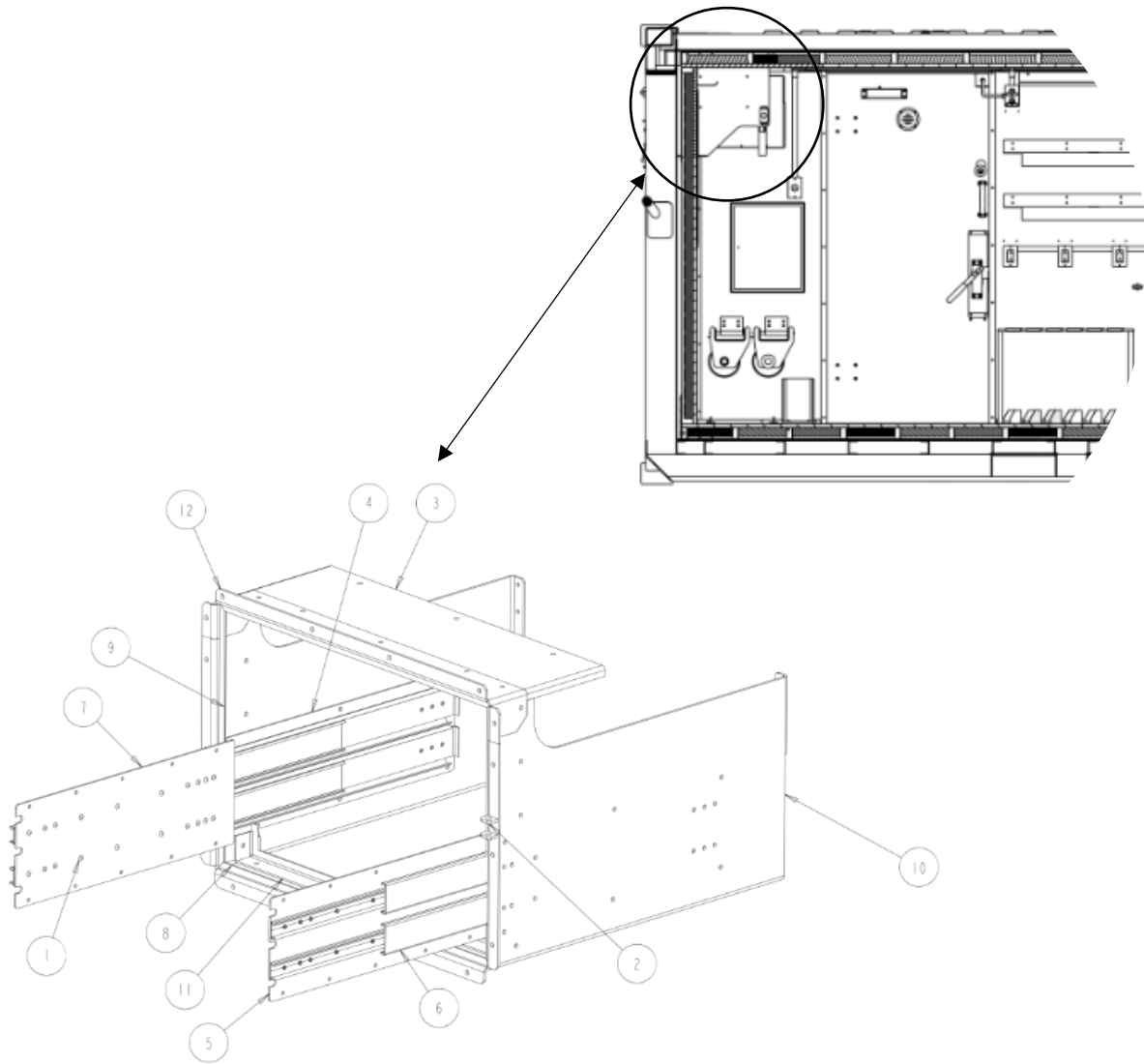

FIGURE 24 – EJOC HVAC SLIDES AND COMPLETE SHROUD ASSEMBLY

(1) ITEM NO.	(2) NSN	(3) CAGEC	(4) PART NUMBER	(5) DESCRIPTION AND USABLE ON CODE (UOC)	(6) QTY
				GROUP 0123 FIGURE 24 EJOC HVAC SLIDES AND COMPLETE SHROUD ASSEMBLY	
1	N/A	1NSG3	15640305	POP RIVET, 3/16 X 1/4 - SB64	40
2	N/A	1NSG3	16370213	HVAC TRANSPORT LOCK TAB A	2
3	N/A	1NSG3	16370215	HVAC DRIP PAN	1
4	N/A	1NSG3	16370350	EJOC HVAC RH GLIDE ASSM	1
5	N/A	1NSG3	16370355	HVAC SLIDE MTG PLT RH	1
6	N/A	1NSG3	16370360	EJOC HVAC LH GLIDE ASSM	1
7	N/A	1NSG3	16370361	HVAC SLIDE MTG PLT LH	1
8	N/A	1NSG3	16370680	HVAC DOOR SEAL WLDMT	1
9	N/A	1NSG3	16370685	HVAC DOOR SEAL WLDMT	1
10	N/A	1NSG3	16370750	EJOC HVAC MAIN SHROUD	1
11	N/A	1NSG3	16370760	HVAC SHROUD TOP RIM	1
12	N/A	1NSG3	16370770	EJOC HVAC BRKT BRACE	1
END OF FIGURE 24					

END OF WORKPACKAGE

This page was intentionally left blank

PARTS SUPPORTING INFORMATION
BOH SOLUTIONS OPERATION MANUAL
(INCLUDING REPAIR PARTS)
EXPEDITIONARY JOINT OPERATIONS CENTER (EJOC®)

NSN INDEX

NSN	FIG.	ITEM
5411-01-529-9175	21	1
5411-01-529-9180	21	3
5411-01-529-9177	21	5
5411-01-529-9178	21	6
5411-01-529-9190	21	8
5411-01-529-9179	21	9
END OF NSN TABLE		

END OF WORKPACKAGE

This page was intentionally left blank

PARTS SUPPORTING INFORMATION

BOH SOLUTIONS OPERATION MANUAL
(INCLUDING REPAIR PARTS)
EXPEDITIONARY JOINT OPERATIONS CENTER (EJOC®)

PART NUMBER INDEX

PART NUMBER	FIG.	ITEM
15100321	3	20
15100324	3	2
15120841	3	3
15121020	3	4
15150120	3	5
15220210	6	4
15312225	20	4
15312225	20	4
15312262	20	7
15312262	20	7
15312267	6	5
15312286	20	3
15312286	20	3
15640305	23	2
15640305	24	1
15640306	23	3
15640324	6	6
15940107	5	3
15940107	5	3
15940107	21	2
15988354	11	7
15988356	11	4
15988476	22	2
15988506	11	2
15988507	11	9
15988508	11	8
15988752	16	2
16190153	16	3
16270051	4	3
16270051	4	3
16270073	4	2
16270073	4	2
16270075	4	4
16270075	4	4
16270082	4	5

PART NUMBER	FIG.	ITEM
16270082	4	5
16270097	9	5
16270097	9	5
16370060	9	7
16370060	9	7
16370151	6	1
16370200	23	4
16370200	23	21
16370213	24	2
16370215	24	3
16370220	23	5
16370250	23	6
16370275	14	1
16370286	23	7
16370307	10	3
16370313	12	3
16370331	12	4
16370331	13	2
16370334	21	4
16370338	17	2
16370341	21	5
16370350	24	4
16370351	23	8
16370352	23	9
16370353	23	10
16370354	23	11
16370355	23	12
16370355	24	5
16370356	23	13
16370357	23	14
16370359	9	6
16370359	9	6
16370360	24	6
16370361	24	7
16370369	23	15

PART NUMBER	FIG.	ITEM
16370371	9	2
16370371	9	2
16370500	9	4
16370500	9	4
16370650	23	16
16370654	23	17
16370680	24	8
16370685	24	9
16370750	24	10
16370760	24	11
16370770	24	12
16370842	3	6
16370852	3	7
16370855	3	8
16370860	3	9
16370871	3	10
16370901	18	1
16370902	19	1
16370912	3	11
16500903	20	5
16500903	20	5
16500905	20	9
16500905	20	9
16500950	20	6
16500950	20	6
16500955	20	8
16500955	20	8
71032226	6	3
71032326	6	2
72270504	22	3
74022005	9	3
74022005	9	3
74050320	3	12
74061244	3	13
74090304	3	14
78100304	3	15

PART NUMBER	FIG.	ITEM
78340108	6	7
78350148	9	9
78350148	9	9
78350310	9	11
78350310	9	11
78370104	3	16
78500420	3	17
78640304	3	18
78640304	5	4
78640304	5	4
78640304	21	3
78674004	23	18
78674030	23	19
78850354	9	10
78850354	9	10
83120139	9	12
83120139	9	12
83120139	23	20
83160006	6	8
94400102	3	19
747070410	9	8
747070410	9	8
15002007-001	1	1
15002007-002	1	1
15100201-001	2	1
15220825-002	23	1
15310001-001	20	1
15310001-002	20	1
15940107-001	7	1
15940107-002	7	1
16190290-001	8	1
16190290-002	8	1
16370910-002	3	1
16500954-001	20	2
16500954-002	20	2
END OF PART NUMBER TABLE		

END OF WORKPACKAGE

BOH Solutions™

Manufacturer's Limited Warranty Terms

BOH Solutions (BOH) warrants that the Products offered, including the Field Pack-Up (FPU®) System, Containerized Mission Systems, Module Kits, and Bare Base Equipment, shall be free from defects in materials and workmanship for a period of twelve (12) months from date of purchase when normally used, maintained and operated by the Customer. Unused Product containing missing or defective components may be returned, within the warranty period, with proof of purchase, to BOH with transportation charges prepaid. BOH, at its option, shall supply a replacement item(s) or refund the purchase price of the Product. BOH shall in its sole discretion determine whether to replace the defective item(s) with identical items, or with items of identical quality and providing identical performance and functional capabilities. BOH will determine, at its sole discretion, whether or not the claim is a valid warranty item. If so, BOH will pay costs (actual transportation plus handling charge) for shipping of the replacement item, when this option is selected.

This warranty is void if Products have been damaged by the Customer as the result of improper or unreasonable use, or other causes not arising out of defects in material or workmanship. The warranty is also void if the Product has at any time been stored or used other than in accordance with the directions set out in the literature relating to the Product (e.g., user/operation manuals). BOH makes no other warranty or representation concerning the Products except that each will meet the performance specifications set forth in the literature relating to the Product. There are no further warranties, including any warranty of merchantability or fitness for a particular purpose covering the Product

BOH will, at its option, either (1) credit user in the amount paid for any Product which does not perform to these specifications, or (2) replace or repair such Product, provided user so notifies BOH within twelve (12) months of the Products purchase date. BOH shall not be responsible for any consequential damages to user arising as a result of such performance. The Customer will return the item at their cost, if required. Boh may elect to have its representative inspect the item to validate the claim.

Other product components included in the fabrication of items purchased under contract (e.g., air conditioners and generators) that are not manufactured by BOH are warranted by their individual manufacturer. Copies of such warranties are supplied with the finished Product or are available through BOH.

Please contact BOH for other contract specific warranty terms

This page was intentionally left blank

THE METRIC SYSTEM AND EQUIVALENTS

Linear Measure

1 centimeter = 10 millimeters = .39 inch
1 decimeter = 10 centimeters = 3.94 inches
1 meter = 10 decimeters = 39.37 inches
1 decameter = 10 meters = 32.8 feet
1 hectometer = 10 decameters = 328.08 feet
1 kilometer = 10 hectometers = 3,280.8 feet

Weights

1 centigram = 10 milligrams = .15 grain
1 decigram = 10 centigrams = 1.54 grains
1 gram = 10 decigrams = .035 ounce
1 dekagram = 10 grams = .35 ounce
1 hectogram = 10 dekagrams = 3.52 ounces

1 kilogram = 10 hectograms = 2.2 pounds
1 quintal = 100 kilograms = 220.46 pounds
1 metric ton = 10 quintals = 1.1 short tons

Liquid Measure

1 centiliter = 10 milliliters = .34 fl. ounce
1 deciliter = 10 centiliters = 3.38 fl. ounces
1 liter = 10 deciliters = 33.81 fl. ounces
1 deciliter = 10 liters = 2.64 gallons
1 hectoliter = 10 deciliters = 26.42 gallons
1 kiloliter = 10 hectoliters = 264.18 gallons

Square Measure

1 sq. centimeter = 100 sq. millimeters = .155 sq. inch
1 sq. decimeter = 100 sq. centimeters = 15.5 sq. inches
1 sq. meter (centare) = 100 sq. decimeters = 10.76 sq. feet
1 sq. decameter (are) = 100 sq. meters = 1,076.4 sq. feet
1 sq. hectometer (hectare) = 100 sq. decameters = 2.47 acres
1 sq. kilometer = 100 sq. hectometers = .386 sq. mile

Cubic Measure

1 cu. centimeter = 1000 cu. millimeters = .06 cu. inch
1 cu. decimeter = 1000 cu. centimeters = 61.02 cu. inches
1 cu. meter = 1000 cu. decimeters = 35.31 feet

APPROXIMATE CONVERSION FACTORS

To change	To	Multiply by	To change	To	Multiply by
Inches	centimeters	2.540	ounce/inches	Newton/meters	0.007062
feet	meters	0.305	centimeters	inches	0.394
yards	meters	0.914	meters	feet	3.280
miles	kilometers	1.609	meters	yards	1.094
square inches	square centimeters	6.451	kilometers	miles	0.621
square feet	square meters	0.093	square centimeters	square inches	0.155
square yards	square meters	0.836	square meters	square feet	10.764
square miles	square kilometers	2.590	square meters	square yards	1.196
acres	square hectometers	0.405	square kilometers	square miles	0.386
cubic feet	cubic meters	0.028	square hectometers	acres	2.471
cubic yards	cubic meters	0.765	cubic meters	cubic feet	35.315
fluid ounces	milliliters	29.573	cubic meters	cubic yards	1.308
pints	liters	0.473	milliliters	fluid ounces	0.034
quarts	liters	0.946	liters	pints	2.113
gallons	liters	3.785	liters	quarts	1.057
ounces	grams	28.349	liters	gallons	0.264
pounds	kilograms	0.454	grams	ounces	0.035
short tons	metric tons	0.907	kilograms	pounds	2.205
pound/foot	Newton/meters	1.356	metric tons	short tons	1.102
pound/inches	Newton /meters	0.11296			

Temperature (Exact)

_F Fahrenheit temperature $\times \frac{5}{9}$ (after subtracting 32) Celsius temperature _C